

Public Document Pack



COMMITTEE:	PLANNING COMMITTEE
DATE:	THURSDAY, 30 APRIL 2020 9.30 AM
VENUE:	VIRTUAL MEETING

Members		
<u>Conservative</u> Melanie Barrett Peter Beer (Chair) Mary McLaren Adrian Osborne	<u>Independent</u> Sue Ayres John Hinton Lee Parker Stephen Plumb (Vice-Chair) <u>Liberal Democrat</u> David Busby	<u>Labour</u> Alison Owen <u>Green</u> Leigh Jamieson

This meeting will be broadcast live to Youtube and will be capable of repeated viewing. The entirety of the meeting will be filmed except for confidential or exempt items. If you attend the meeting and make a representation you will be deemed to have consented to being filmed and that the images and sound recordings could be used for webcasting/training purposes.

The Council, members of the public and the press may record/film/photograph or broadcast this meeting when the public and the press are not lawfully excluded.

AGENDA

PART 1

MATTERS TO BE CONSIDERED WITH THE PRESS AND PUBLIC PRESENT

Page(s)

1 SUBSTITUTES AND APOLOGIES

Any Member attending as an approved substitute to report giving his/her name and the name of the Member being substituted.

To receive apologies for absence.

2 DECLARATION OF INTERESTS

Members to declare any interests as appropriate in respect of items to be considered at this meeting.

3 PL/19/28 TO CONFIRM THE MINUTES OF THE MEETING HELD ON 11 MARCH 2020

To Follow.

4 **TO RECEIVE NOTIFICATION OF PETITIONS IN ACCORDANCE WITH THE COUNCIL'S PETITION SCHEME**

5 **SITE INSPECTIONS**

In addition to any site inspections which the Committee may consider to be necessary, the Acting Chief Planning Officer will report on any other applications which require site inspections.

6 **PL/19/29 PLANNING APPLICATIONS FOR DETERMINATION BY THE COMMITTEE** 5 - 12

An Addendum to Paper PL/19/29 will be circulated to Members prior to the commencement of the meeting summarising additional correspondence received since the publication of the agenda but before 12 noon on the working day before the meeting, together with any errata.

a **DC/18/02010 & DC/18/02412 LAND ON THE EAST SIDE OF BRAMFORD ROAD, (KNOWN AS LORRAINE WAY), SPROUGHTON, SUFFOLK** 13 - 54

Notes:

1. The Council has adopted Public Speaking Arrangements at Planning Committees, a link is provided below:

[Public Speaking Arrangements](#)

Those persons wishing to speak on an application to be decided by Planning Committee must register their interest to speak no later than two clear working days before the Committee meeting, as detailed in the Public Speaking Arrangements (adopted 30 November 2016).

Those wishing to speak must contact the Governance Officer on the details below to receive instructions on how to join the meeting.

The registered speakers will be invited by the Chairman to speak when the relevant item is under consideration. This will be done in the following order:

- A representative of the Parish Council in whose area the application site is located to express the views of the Parish Council;
- An objector;
- A supporter;
- The applicant or professional agent / representative;
- County Council Division Member(s) who is (are) not a member of the Committee on matters pertaining solely to County Council issues such as highways / education;

- Local Ward Member(s) who is (are) not a member of the Committee.
- Public speakers in each capacity will normally be allowed **3 minutes** to speak.

Local Ward Member(s) who is (are) not a member of the Committee are allocated a maximum of **5 minutes** to speak.

Please Note:

The Chair has agreed that due to the applications being in the same report 3 minutes in total will be allowed for each speaking slots on DC/18/02010 and 3 minutes will be allowed each the speaking slots on DC/18/02412.

When registering to speak please indicate which application you wish to speak on and in which capacity.

Date and Time of next meeting

Please note that the next meeting is scheduled for Wednesday, 6 May 2020 at 9.30 am.

Webcasting/ Live Streaming

The Webcast of the meeting will be available to view on the Councils Youtube page:
https://www.youtube.com/channel/UCSWf_0D13zmegAf5Qv_aZSg

For more information about this meeting, including access arrangements and facilities for people with disabilities, please contact the Committee Officer, Robert Carmichael - committees@babberghmidsuffolk.gov.uk - 01449724930

Introduction to Public Meetings

Babergh/Mid Suffolk District Councils are committed to Open Government. The proceedings of this meeting are open to the public, apart from any confidential or exempt items which may have to be considered in the absence of the press and public.

Domestic Arrangements:

- Toilets are situated opposite the meeting room.
- Cold water is also available outside opposite the room.
- Please switch off all mobile phones or turn them to silent.

Evacuating the building in an emergency: Information for Visitors:

If you hear the alarm:

1. Leave the building immediately via a Fire Exit and make your way to the Assembly Point (Ipswich Town Football Ground).
2. Follow the signs directing you to the Fire Exits at each end of the floor.
3. Do not enter the Atrium (Ground Floor area and walkways). If you are in the Atrium at the time of the Alarm, follow the signs to the nearest Fire Exit.
4. Use the stairs, not the lifts.
5. Do not re-enter the building until told it is safe to do so.



PL/19/29

BABERGH DISTRICT COUNCIL

PLANNING COMMITTEE

25 MARCH 2020

SCHEDULE OF APPLICATIONS FOR DETERMINATION BY THE COMMITTEE

Item	Page No.	Application No.	Location	Officer
6A	13-54	DC/18/02010 & DC/18/02412	Land on the East side of Bramford Road, Sproughton	JH

Philip Isbell
Chief Planning Officer

BABERGH DISTRICT COUNCIL

PLANNING COMMITTEE

SCHEDULE OF APPLICATIONS MADE UNDER THE TOWN AND COUNTRY PLANNING ACT 1990, AND ASSOCIATED LEGISLATION, FOR DETERMINATION OR RECOMMENDATION BY THE PLANNING COMMITTEE

This Schedule contains proposals for development which, in the opinion of the Acting Chief Planning Officer, do not come within the scope of the Scheme of Delegation to Officers adopted by the Council or which, although coming within the scope of that scheme, she/he has referred to the Committee to determine.

Background Papers in respect of all of the items contained in this Schedule of Applications are:

1. The particular planning, listed building or other application or notification (the reference number of which is shown in brackets after the description of the location).
2. Any documents containing supplementary or explanatory material submitted with the application or subsequently.
3. Any documents relating to suggestions as to modifications or amendments to the application and any documents containing such modifications or amendments.
4. Documents relating to responses to the consultations, notifications and publicity both statutory and non-statutory as contained on the case file together with any previous planning decisions referred to in the Schedule item.

DELEGATION TO THE ACTING CHIEF PLANNING OFFICER

The delegated powers under Minute No 48(a) of the Council (dated 19 October 2004) includes the power to determine the conditions to be imposed upon any grant of planning permission, listed building consent, conservation area consent or advertisement consent and the reasons for those conditions or the reasons to be imposed on any refusal in addition to any conditions and/or reasons specifically resolved by the Planning Committee.

PLANNING POLICIES

The Development Plan comprises saved policies in the Babergh Local Plan adopted June 2006. The reports in this paper contain references to the relevant documents and policies which can be viewed at the following addresses:

The Babergh Local Plan: <http://www.babergh.gov.uk/planning/planning-policy/adopted-documents/babergh-district-council/babergh-local-plan/>

National Planning Policy Framework:

<http://www.communities.gov.uk/documents/planningandbuilding/pdf/2116950.pdf>

LIST OF ABBREVIATIONS USED IN THIS SCHEDULE

AWS	Anglian Water Services
CFO	County Fire Officer
LHA	Local Highway Authority
EA	Environment Agency
EH	English Heritage
NE	Natural England
HSE	Health and Safety Executive
MoD	Ministry of Defence
PC	Parish Council
PM	Parish Meeting
SPS	Suffolk Preservation Society
SWT	Suffolk Wildlife Trust
TC	Town Council

This page is intentionally left blank

Protocol for Virtual Planning Meetings

Live Streaming:

1. The meeting will be held on Skype and speakers will only be able to join via invite only.
2. The meeting will be live streamed and will be available to view on the Council's YouTube page as detailed below:
https://www.youtube.com/channel/UCSWf_OD13zmegAf5Qv_aZSg

Communications with Councillors

1. As the committee is not in the Council chamber and the general rules of interference/ communication still apply that if Councillors are contacted by any third parties regarding the application before members/ on the agenda that they contact the Governance Officer/ Chair immediately to bring this to their attention.

Recording of proceedings:

1. Proceedings will be held in an Audio only format apart from presentations from the Case Officer where they will present their screen for the presentation.
2. A Second Governance Officer will be present to take notes as it is anticipated that the main Governance Officer will be controlling the skype call.

Roll Call:

1. A roll call of all Members present will be taken during the Apologies of Absence/ Substitutions to confirm all members present at the meeting.

Disclosable Pecuniary Interests:

1. Where a Member of the Committee has a disclosable Pecuniary Interest in an application they must mute themselves for the entirety of the application and must not participate in any way.

Officer Presentation:

1. The Case Officer will introduce themselves and the application and would proceed to present their item in the normal fashion with the only difference being that they would present their desktop to the skype call. This enables everyone on the call to view the presentation in real time and allow public speakers to view the presentation as well. This also includes viewers on the live stream.

Public Speaking:

1. There will be one public speaker for each slot (Parish Council, Objector, Supporter, Applicant/Agent) This is communicated on the agenda and will be on a first come first serve basis.
2. The Speaker(s) will be advised to join the call at the beginning of the meeting so that they can hear the entirety of proceedings/ to be present if there is any change in the running order of the agenda/ any issues of items being withdrawn (this is no different from normal proceedings).
3. Once the initial presentation from the officer/ questions of officer has completed the public speaker will be invited to address the meeting by the Chair.
4. The Speaker will have their allotted 3 minutes (5 Minutes for Ward Member) as timed by the Governance Officer / Chair.
5. If there are any questions it is proposed that Members would be taken in alphabetical order whereby the chair would essentially go down the list and ask if the Committee have any questions.
6. Members are also asked, if possible, to submit their questions to Officers in advance of the meeting.

Debate:

1. As previously stated with the Public speaking above it is proposed that the committee would essentially go down the list and ask the committee whether they have any points to make . This would take place once during the normal debate. Members would then have the option to speak again on any motion.
2. In the instance where a Member of the Committee would like to formally propose an action they could either do this when they are called on the list or they could send a skype message to the governance officer/ Chair to say that they would like to propose something. At this point the Chair would go directly to them and take the proposal. Once the proposal has been made the Chair would immediately ask if there was a seconder to the motion. If there is it would become the substantive motion and the Chair would again continue down the list of councillors until there is no further debate.

Voting:

1. Once a substantive motion is put before the committee and there is no further debate then a vote will be taken.
2. Due to circumstances the current voting by a show of hands would be impractical- as such it is proposed that the Governance officer would ask the committee for their vote in the same way as a recorded vote would be. However the difference here would be that the votes would not be recorded in the minutes unless the requirement for a recorded vote was asked for at the meeting via the usual proposal.
3. The governance officer would then read out the result for the Chair to confirm.

Skype Meeting Etiquette

- Mute when you are not speaking: To minimise background noise and ensure everyone can be heard.
- Always introduce yourself before speaking: As it can be hard to identify a person just by his or her voice.
- Address other participants by name: This keeps the conversation flowing and everyone can be heard.
- Speak loudly and clearly: To ensure everyone can hear you.
- Don't Interrupt others: When others are talking, always let them finish before offering a thought of your own.
- Send an instant message to indicate you wish to speak: To maintain a controlled meeting and avoid interruptions.
- Give the meeting your full attention: Activities such as typing during a meeting can create a distracting noise.
- Anyone persistently interrupting or disrupting the meeting will be removed or asked to leave.

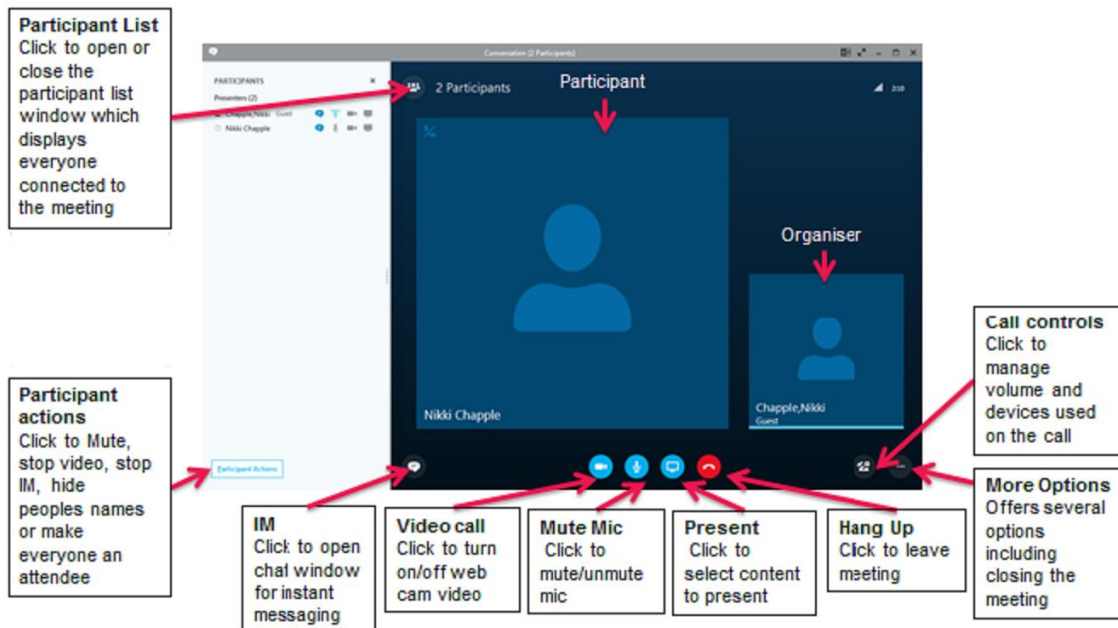

This page is intentionally left blank

Agenda Item 6a

Committee Report

Item 6A

Reference: DC/18/02010 and DC/18/02412

Case Officer: Jo Hobbs

Ward: Sproughton & Pinewood.

Ward Member/s: Cllr Richard Hardacre. Cllr Zachary Norman.

RECOMMENDATION – APPROVE PLANNING PERMISSION WITH CONDITIONS

Description of Development

Full Planning Application (duplicate applications of DC/18/02412 and DC/18/02010) - Residential development of 49 dwellings with new vehicular access from Bramford Road (B1113), associated parking, landscaping and open space.

Location

Land On The East Side Of, Bramford Road (known as Loraine Way), Sproughton, Suffolk

Expiry Date: 27/03/2020

Application Type: FUL - Full Planning Application

Development Type: Major Small Scale - Dwellings

Applicant: Hopkins Homes

Agent: Strutt & Parker

Parish: Sproughton

Site Area: 3.45

Density of Development:

Gross Density (Total Site): 14.2 dwellings per hectare (dph)

Net Density (Developed Site, excluding open space and SuDs): 20 dph

Details of Previous Committee / Resolutions and any member site visit:

A Member Site Visit was previously held in 2019, and also more recently on 19th February 2020.

Members resolved to refuse duplicate application DC/18/02010 at Babergh Planning Committee on 17th April 2010 for the following reason:

“The proposed development is considered to lead to a medium level of less than substantial harm to the setting of the Grade II listed buildings of Sproughton Hall, Root Barn and Tithe Barn and the Grade II* listed All Saints Church in Sproughton, which is not considered to respect the features that contribute positively to the setting of these listed buildings, conflicting with Babergh Local Plan (2006) policy CN06, and not respect the heritage characteristics of the village or historic views of heritage assets contrary to Babergh Core Strategy and Policies (2014) policies CS11 and CS15. Further to this, the public benefits of the scheme, namely the housing,

affordable housing, net gain for biodiversity on the site, are not considered to outweigh this harm, making the proposal contrary to paragraph 196 of the National Planning Policy Framework 2019.”

The Minutes to this committee can be found in Appendix 1 of this committee report.

The applicants also submitted a duplicate application shortly after 18/02/2010 was submitted. The development in both applications is identical. The applicants have revised plans to respond to flood risk and heritage issues. These matters are considered further in the report below.

As a matter of record, it is important for Members to appreciate the need for consistency in decision-taking and it must be noted, therefore, that Members had previously resolved to refuse planning permission. However, it is the opinion of your officers that the application has evolved and the development amended to such a material degree that a refreshed decision is required with Members approaching that decision with an open mind. This is especially the case bearing in mind that through the passage of time the Applicant has sought to make changes in order to overcome the deficiencies identified by Members previously.

Has a Committee Call In request been received from a Council Member (Appendix 1): No

Has the application been subject to Pre-Application Advice: Yes DC/17/04502

Summary of advice: Whilst the site is valued for its undeveloped character and this contributes to the qualities of the Special Landscape Area and historic environment, advised development on the site could be possible with a sensitively designed scheme, but proposal for 76 dwellings required fundamental changes to address heritage and design issues and that without these changes Officers minded to recommend refusal.

PART ONE – REASON FOR REFERENCE TO COMMITTEE

The application is referred to committee for the following reason/s:

It is a “Major” application for:

- a residential land allocation for 15 or more dwellings

PART TWO – POLICIES AND CONSULTATION SUMMARY

Summary of Policies

Babergh Core Strategy 2014:

- CS1 Applying the Presumption in favour of sustainable development in Babergh
- CS2 Settlement Pattern Policy
- CS3 Strategy for Growth and Development
- CS11 Strategy for Development for Core and Hinterland Villages
- CS12 Sustainable Design and Construction Standards
- CS13 Renewable / Low Carbon Energy
- CS14 Green Infrastructure
- CS15 Implementing Sustainable Development in Babergh
- CS18 Mix and Types of Dwellings
- CS19 Affordable Homes
- CS21 Infrastructure Provision

Saved Policies in the Babergh Local Plan (2006):

- HS31 Public Open Space (Sites of 1.5ha and above)
- CR04 Special Landscape Areas
- CR07 Landscaping Schemes
- CR08 Hedgerows
- CN01 Design Standards
- CN04 Design and Crime Prevention
- CN06 Listed Buildings – Alteration/Extension/Change of Use
- TP15 Parking Standards – New Development

Supplementary Planning Documents

- Rural Development and Policy CS11 (2014)
- Affordable Housing (2014)
- Supplementary Planning Guidance on Provision of Outdoor Recreation Facilities and Open Space 2010

Other material planning considerations

National Planning Policy Framework 2019

Emerging Joint Local Plan – Preferred Options (Regulation 18) Consultation (July 2019)

Suffolk County Council Adopted Parking Standards

Suffolk County Council Minerals Core Strategy 2008 – Policy 5

Suffolk County Council Emerging Minerals and Waste Local Plan (2018) – Policy MP10

Sproughton Action Plan 2010 (n.b. this does not form part of the development plan but is considered to be a material consideration)

Neighbourhood Plan Status

An area has been designated for Sproughton Neighbourhood Development Plan in April 2020.

Consultations and Representations

During the course of the application Consultation and Representations from third parties have been received. These are summarised below.

A: Summary of Consultations

Town/Parish Council

Cllr Christopher Hudson (Suffolk County Council)

Comments on original scheme for 54 dwellings:

Many Sproughton residents have objected to the Hopkins Homes development, on the basis of:
Unsustainable traffic congestion.
Consequential pollution.
Unsustainable infrastructure demands
The relevant nature of the proposed new development.

For these reasons, may I raise them as relevant planning objections to the proposal as the local County Councillor.

Cllr Zac Norman

Comments on current scheme for 49 dwellings

Object: concern over current highway capacity and future with this proposed development; air pollution from traffic relating to existing and proposed development; adverse impact on river valley and Special Landscape Area; flood risk on the site; impact on wildlife corridors; adverse impact on education and healthcare infrastructure; poor bus services to village; development out of keeping with village setting; light pollution harmful to local amenity and Special Landscape Area; impact on listed buildings; creeping coalescence with Ipswich from all proposed development in village; precedent for further development in village; insufficient public benefits to weigh against the harms, not proposed in the emerging Joint Local Plan; coalescence with Bramford; and Housing Needs Survey commissioned by Sproughton Parish Council indicates housing need only 12-15 homes in village.

Sproughton Parish Council

Comments on original scheme for 54 dwellings:

1st response: Object: Concern over level of development proposed for Sproughton, impact on open countryside, landscape and creeping coalescence, traffic impact and in cumulation with other planned/emerging developments, setting, style and layout – development does not reflect this part of the village, impact on setting of heritage assets, flood risk and concern over surface water drainage strategy and foul water and sewerage disposal concerns.

2nd response: In response to the publication of the Babergh and Mid Suffolk Joint Annual Monitoring Report on 11 July 2018, SPC wishes to make further representations of objection.

Monitoring Report states that, as of 11th July 2018 Babergh has a 6.7 year Housing Land Supply based on figures derived from the Adopted Local Plan Core Strategy site allocations. NPPF requires applications for planning permission to be determined in accordance with the development plan unless material considerations indicate otherwise. The proposed development site is not allocated in the adopted local plan for development and as such it is outside the defined built up area of Sproughton and is in open countryside. The adopted Local Plan has sufficient Housing Land Supply to pass the 5 year test and is therefore considered up-to-date. The application cannot therefore be considered within the context of presumption in favour of sustainable development. The emerging Joint Local Plan is at a very early stage of preparation and there has been no consultation carried out in response to objections to housing allocations put forward in the draft plan. In reference to the NPPF, little, if no weight, can

therefore be given to the emerging Joint Local Plan in relation to presumption in favour of sustainable development. The granting of planning permission for this development would prejudice the outcome of the current Plan making process as it would set a precedent over other sites which also appear within the emerging Local Plan and lead to a windfall approach to site development approvals and severely and materially undermine the principle of plan led development. The proposal is premature, and Sproughton Parish Council objects to the proposal and recommends that the LPA refuse to grant planning permission.

3rd response: Still object to planning application. Unsustainable development in the wrong place, does not consider Special Landscape Area designation on site, adverse impact on open countryside and creeping coalescence with Bramford, undermines plan-led process, highway and traffic impacts, setting and layout of proposed development failing to take account of listed buildings, flooding and surface water disposal from site, sewage disposal when there are existing issues at the Old Police House, lack of infrastructure for health, education and travel in cumulation with other applications in area, impact on biodiversity and lack of information on deer and dormice in submitted surveys.

Sproughton Working Group Findings: impact on Special Landscape Area, loss of best and most versatile agricultural land and open countryside, development impacts on listed buildings, creates light pollution, leads to creeping coalescence, adverse cumulative impact including in relation to traffic, no public benefits, sewerage system frequently overflows, landscape impact, does not support rural community or services, impact on river valley, design, scale and layout not in keeping with village, on fringe of village, already 2300 dwellings planned for parish, no doctors or dentists or capacity in schools, loss of open space, visual impact and effect on character of neighbourhood, loss of views and residential amenity, cumulative effect on tranquil area and air pollution, allocated land being developed so question why greenfield land needs to be developed, loss of open character of meadows and soft transition from open countryside to village, urbanising effect, development would demonstrably harm the character and appearance of the area and amenities enjoyed by residents, 2,310 homes proposed for Sproughton through emerging local plan, suggest pro-rata growth across parishes, no provision for wildlife corridors, consider harms outweigh public benefit which does not justify harm to heritage assets.

Comments on current scheme for 49 dwellings:

Object: impact on listed and non-listed buildings and settings with rural landscape; adverse impact on Gipping valley and Special Landscape Area; access to A14 poor and adverse impact on B1113 from increased traffic; not a sustainable location due to poor access to A14; settlement coalescence with Bramford; wildlife impact; insufficient sewerage capacity; insufficient surface water strategy; flood risk on site and from proposed development; cumulative impact of development on area; loss of best and most versatile agricultural land; poor design; impact on listed buildings; light pollution; no public benefits, harms not outweighed by public benefits; does not support rural community or local services; impact on road network; insufficient education and healthcare infrastructure; 2,310 dwellings identified in 'Sites Submitted' document which is 55% of housing requirement for district and should be dispersed amongst parishes rather than concentrated in Sproughton.

A housing needs survey for Sproughton parish has also been submitted by the parish council. The key findings of this report were that from 38 households that responded, a housing need for 87 people was identified.

National Consultee

Historic England

Comments on both original scheme for 54 dwellings and current scheme for 49 dwellings:

Do not wish to offer comments.

Environment Agency

Comments on original scheme for 54 dwellings

No objection: provided local planning authority take account of flood risk.

Comments on scheme for 49 dwellings

No further comments to make. Site sequentially sited away from higher flood risk and built footprint in flood zone 1 with safe access and egress.

Natural England

Comments on original scheme for 54 dwellings:

Insufficient info to assess impact on Stour and Orwell Estuaries Special Protection Area (SPA) and Ramsar site, and Orwell Estuary Site of Special Scientific Interest (SSSI). Habitats Regulations Assessment (HRA) needed and contribution to Recreational Disturbance Avoidance and Mitigation Strategy (RAMS).

Comments on scheme for 49 dwellings

Further information required to determine the recreational disturbance impacts of this development, a Habitats Regulations Assessment (HRA) needs to be undertaken.

Officer response: Further correspondence with the Council's Ecologist has confirmed that a Stage 2 HRA is not required as the scheme is under 50 dwellings.

Highways England

No objections.

Anglian Water

No objection: Assets owned by Anglian Water on site, permission required before works commence. Available capacity for foul water drainage at Sproughton Church Lane Water Recycling Centre. Surface water strategy unacceptable, no evidence to show surface water hierarchy has been met. Before connection to the public water surface sewer is permitted, confirmation of intended manhole connection point and discharge rate required.

Suffolk Preservation Society

Comments on original scheme for 54 dwellings:

Previously raised concerns about the harmful impact of the development on the setting of designated heritage assets including Sproughton Hall, Tithe Barn, Root Barn and the All Saints Parish church.

We welcome the revisions to the layout which show a significantly increased area of open space between Sproughton Hall, Tithe Barn, Root Barn and the new dwellings which will mitigate the heritage impact. We also consider that the revised layout has addressed our previous concern over the loss of view across the site from Bramford Road towards the heritage assets including the tower of the Church of All Saints. The revised orientation of the access road into the development and the layout of the dwellings should now retain this important view.

With regards to the design we are pleased that previous units 15-18 have been removed from the scheme as we had serious concerns regarding their design, glazing and balconies. However we continue to urge that the wall and roof materials of the proposed dwellings are informed by the village character and house types seen throughout Sproughton.

NHS England

No objection: Two GP practices within a 2.5km radius, one of these surgeries has a main surgery that could be affected by proposed development. These practices do not have sufficient capacity for the

additional growth, therefore a contribution via Community Infrastructure Levy towards the capital funding to increase capacity will be sought for extension, refurbishment or reconfiguration at Hawthorn Drive Surgery and Pinewood Surgery (a branch of Derby Road Practice).

Cadent Gas and National Grid

No objection: Gas apparatus and overhead power lines within the application site boundary, the applicant will need to ensure works do not infringe on easements or wayleaves on site.

County Council Responses

Suffolk County Council (SCC) Highways

Comments on original scheme for 54 dwellings:

1st response: Plan to demonstrate visibility splays required.

2nd response: Cumulative impact of developments in surrounding area requires consideration. Junctions B1113/Burstall Road/Lower Street and A1071/Swan Hill/High Street roundabout at or over capacity.

3rd response: Cumulative impact to be considered. Potentially severe delays at Station Road/Norwich Road, Church Road/Ipswich Road, Loraine Way/Lower Street/Burstall Road. Junctions experience issues during AM or PM peak hours, with worse performing movements for right turning vehicles. With increased congestion vehicles likely to turn to other routes which are unsuitable for increase in traffic. Pedestrian safety could also be compromised where pedestrians are trying to cross roads between queuing cars so not visible to other drivers. Potential for increase queuing and delays for all users.

4th response: No objections subject to conditions. Information submitted with the application shows that required visibility splays can be met; the traffic generated by this development and cumulatively with other proposals in the area can be adequately mitigated against significant impacts; accident data has been reviewed and there are no patterns and no sections of highway where the layout or design has resulted in collisions in the last five years; pedestrian access provides connectivity to bus stops (within 100m of centre of site) and the wider footway network; catchment primary school 0.4 miles with a continuous footway link; high school is 3.7 miles with no continuous footway/cycle link. Conditions include provision of visibility splays, details of access, details of estate roads and footpaths, provision of carriageways and footways to binder course level prior to occupation, construction management plan, discharge of surface water, residents travel pack, manoeuvring and parking details and refuse/cycling bin presentation and storage details. A CIL contribution of £5,000 will be sought to make improvements to existing bus stops to make them wheelchair accessible kerbs. S106 contributions required to address cumulative impact of this and other proposals in area to include:

- B1113 - New zebra crossing north of Wild Man PH access - £15,050
- B1113/Burstall Lane/Lower Street Junction – Reduce kerb radii and install uncontrolled crossing points
- A1071/B1113 Beagle Roundabout – Widening of approach lanes to roundabout - £5,050
- Footway between Sproughton and Bramford – Cycle link on Loraine Way - £25,050

Comments on scheme for 49 dwellings

No further comments to those made above.

SCC Strategic Development

Comments on original scheme for 54 dwellings:

No objection subject to S106 contributions and CIL monies.

Comments on scheme for 49 dwellings

Previous responses set out position, aside from updated contributions required due to revised dwelling numbers: CIL monies required as follows: Primary school expansion at Sproughton CofE Primary School

- £182,556; Secondary school expansion - £181,904; Sixth Form expansion - £45,476; Libraries improvement - £10,584; Waste infrastructure - £5,390.

SCC Lead Local Flood Authority (LLFA)

No objections subject to conditions.

SCC Minerals and Waste

No objection: site falls within a mineral safeguarding zone and ask that an assessment of minerals resource is conducted, if materials found a strategy should be formed on how the resource is to be used that can then be conditioned as part of any permission. If material is economically viable prior extraction or use on site should be considered.

SCC Archaeological Service

Comments on original scheme for 54 dwellings:

No objection: An archaeological evaluation including geophysical and trial trenching now undertaken. Archaeological features include a ring ditch likely to relate to the remains of a prehistoric burial mound, as well as Anglo Saxon and medieval ditches. High potential for below-ground heritage assets of archaeological importance, and groundworks associated with the development will destroy archaeological remains which are known to survive in the development area. There are no grounds to consider refusal in order to achieve preservation in site of any important heritage assets. However in accordance with paragraph 199 of the NPPF any permission granted should be the subject of a planning condition to record and advance understanding of the significance of any heritage assets before it is damaged or destroyed.

Comments on scheme for 49 dwellings

No further comments, no objection subject to conditions.

SCC Fire Service

Comments on original scheme for 54 dwellings:

No objection: Fire hydrants to be secured through condition, consider installing fire sprinklers, and that access for fire-fighting appliances and water supplies are sufficient.

Suffolk Police

Suffolk Police (made on application 18/02412 on original plans for 64 dwellings, no further comments received on revised scheme): A number of concerns raised regarding potential for crime and anti-social behaviour relating to the open car ports, parking areas to rear of properties, rear footpaths and surveillance of footpaths, open space and permeability of the development to pedestrians. Recommend the principles of Secure by Design are followed.

Officer response: The scheme has been revised since these comments were made.

Internal Consultee Responses

Place Services: Ecology

Comments on original scheme for 54 dwellings:

1st response: Objection due to insufficient information on protected and priority species, contribution required to RAMS and HRA required to be undertaken by Local Planning Authority (LPA) to consider the likely impacts from recreational disturbance from this residential development required, including a potential 2.7km daily dog-walking route within local footpath network.

2nd response: No objection subject to conditions to secure visitor management measures and ecological mitigation and enhancements. The Extended Phase 1 Habitat Survey Feb 2018, Phase 2 Ecological

Surveys and Assessment Dec 2018, and Habitats Regulations Assessment Report Rev B Feb 2018 provides sufficient information to address previous concerns.

Comments on scheme for 49 dwellings

Further to receipt of updated ecology assessment (given the age of the previous assessment) for the site, no objection subject to conditions and financial contribution to secure recreation disturbance mitigation.

Place Services: Landscape

Comments on original scheme for 54 dwellings:

No objections: Proposed development would have an inevitable adverse impact on landscape character and visual amenity of Sproughton and the Gipping Valley Special Landscape Area. However, proposed design does identify landscape mitigation measures that will help reduce the impact both short and long term. Suggested conditions of detailed hard and soft landscaping scheme and landscape management plan.

Comments on scheme for 49 dwellings

No objection subject to conditions. Revised landscaping strategy and increased green open space welcomed, suggest low-medium shrub planting along eastern boundary to strengthen existing landscaping buffer. Review of proposed boundary treatment and surface treatment required through discharge of condition, sensitive use of boundary treatment will be required to avoid unnecessary fencing and reduce the use of different surface materials on small areas. Landscaping will be required to reduce visual impact of parking courts and long brick wall elevations which can be conditioned.

Babergh and Mid Suffolk District Councils (BMSDCs) Strategic Housing

Comments on original scheme for 54 dwellings:

Affordable dwellings - 19 required on site, including 15 affordable rent and 4 shared ownership. Note growing demand for smaller homes in market dwellings, and two to three bedroom bungalows, apartments and houses. Suggest a broader range of properties to include flats/apartments, terraced, semi-detached and detached houses, and where appropriate bungalows for older people wishing to downsize.

Comments on scheme for 49 dwellings

No objection: would prefer a higher proportion of two bedroom dwellings and 1 bedroom flats/apartments. Request for affordable housing mix of 13 affordable rent - 6 x 1b 2p apartment, 7 x 2b 4p house; and 4 shared ownership - 2 x 2b 4p terraced/semi-detached house and 2 x 3b 5p terraced house.

BMSDCs Heritage

Comments on original scheme for 54 dwellings:

Consider the Heritage Impact Assessment submitted with the application does not appropriately identify the setting for various listed buildings around the application site. In regard specifically to the proposed layout, three views across the development land towards the Church have been identified, and state that 'the retention of these views would help to preserve the context and extended setting of the church as a key landmark building identifying the historic core of the village from the north-west'. The Heritage Team is not convinced that in manufacturing specific views which are currently broadly available to those moving along Bramford Road, could it be argued that the 'extended setting' of the Church is preserved, nor is reducing the amount of open space around these heritage assets help to preserve the immediate setting of these buildings.

In conclusion therefore, whilst it is acknowledged that the development is less harmful to the significance of the various assets than it was previously, the Heritage Team considers the development would harm the settings of the Hall, the Root Barn, the Tithe Barn and the Church. The development is therefore contrary to the requirements of the P(LBCA)A1990, the NPPF and the policies within the Local Plan. In

terms of the NPPF the development would cause a *medium level of less than substantial harm* - and it is for these reasons the Heritage Team does not support the development.

Comments on current proposal for 49 dwellings

Do not support: proposals would lead to a medium level of less than substantial harm. Disagree with extent of settings of listed buildings as set out by the applicant. The settings of all the assets 'nest' and overlap, including the Church, no.s 1-4 Church Close, Sproughton Hall, the Tithe Barn, the Root Barn, the Corn Mill and Mill House. Their closely interlinked uses and the cultural identity that their uses generated through several centuries have resulted in a group of buildings that notably amplify the significance of the entire area around them. The development would harm the settings of the Hall, the Root Barn, the Tithe Barn and the Church.

Officer response: These issues are considered further in the report below.

BMSDCs Environmental Health: Noise/Odour/Light/Smoke

No objections: Subject to conditions to protect existing residents during construction phase.

BMSDCs Environmental Health: Contamination

No objection: Risk of contamination low, suggest condition on unexpected contamination.

BMSDCs Environmental Health: Air Quality

No objection: scale of development unlikely to compromise the existing air quality.

BMSDCs Environmental Health: Sustainability

Object: Further information required on how 10% reduction in carbon dioxide emissions from renewable energy achieved on site, along with sustainable construction methods. Condition sustainability and energy strategy if approved.

Officer response: The information requested could reasonably be provided through condition.

BMSDCs Arboricultural Officer

No objection: Subject to conditions set out in arboricultural report. Although a number of trees are proposed for removal they are of limited amenity value and/or poor condition. Request condition for detailed Arboricultural Method Statement and Tree Protection Plan.

BMSDCs Public Realm

Objection: Welcome considerable areas of open space within the development, but no details given on how this would be provided on site. Object on grounds of lack of evidence of any play provision.

Officer response: There is sufficient space for play space to be provided on site, which would be secured through a S106 agreement along with management arrangements.

B: Representations

At the time of writing this report at least 250 letters/emails/online comments have been received. A verbal update shall be provided as necessary.

DC/18/02010 - 251 Contributors – 250 Objections, 1 Neutral

DC/18/02412 - 265 Contributors - 264 Objections, 1 Neutral

Views are summarised below:-

Objections based on:

- Visual and historical importance to the village
- Blocking countryside views to current houses, loss of outlook
- In Special Landscape Area and National Character Area, landscape impact
- Inappropriate near grade II listed buildings and other historic properties, the proposal would have a severe impact on their rural and agricultural setting
- Out of character with the village and area (including solar panels)
- Further visual impact assessment required
- Inappropriate location for village amenities
- No public benefit (NPPF paragraph 196)
- Dilution of village life
- Poor design and unsympathetic to area (NPPF paragraph 127)
- New properties will cause overlooking / lack of privacy
- Estate footpath running alongside houses back gardens causing concerns about privacy and security/crime
- Increased risk of flooding, with proposed drainage system not accommodating for the proximity to the river / flood banks
- Wildlife and Ecological issues
- Loss of green spaces, particularly the historic village green
- Urbanising countryside / Inappropriate in a rural setting
- Environmental issues (light, noise and air pollution)
- Disruption caused by any future building works (noise, dirt and traffic issues)
- Health issues (car fumes)
- Mature trees on boundary of land
- Too close to river
- Loss of high-quality agricultural land
- Highways issues with increased traffic and fears of high-speed traffic
- Inadequate infrastructure in place
- Overdevelopment of the village and out of scale
- Compounding impact of other large development proposals in neighbouring villages
- In excess of local housing needs
- Development is too high density, there is already a large number of unoccupied properties in the area
- Development outside local plan and settlement boundary
- Conflict with neighbourhood plan
- Area not a key site for delivery of housing strategy
- Strain of village amenities, services and facilities with no additional support or facilities offered – specific concerns regarding healthcare and school facilities
- Strain on sewage system and inadequate system for surface water
- Lack of employment in the village
- Unaffordable houses
- Proposal does not promote sustainable development (economic, social and environmental)
- Development should be considered after Joint Local Plan adopted
- Concerns that development will set a precedent for further development
- Concerns development will create a shortage in parking spaces, particularly for the local shops and exacerbating pre-existing parking issues
- The proposal constitutes Ribbon development
- Against policy RLP2

- The proposed development would join Sproughton up with Ipswich and Bramford, which should be avoided at all costs or the village will lose its identity and become a suburb
- Investors taking advantage of small community
- Modern technology allows for better materials and conservation, water drainage, sewage treatment and energy efficiency which are not detailed in plans
- Will not enhance quality of life for existing residents
- The Council can now demonstrate a 5-year land supply, so this development is not needed
- Development plans and statements in scale and language which makes them unclear to public
- Development not considering compounding effect of other applications in areas
- Development will take away rural river walks and picturesque views
- Errors in the agent's provided impacts reports, especially in relation to heritage issues
- Habitats impact assessment provided does not give enough information on the impact the development would have on the surrounding area
- Inadequate information and detail
- Proposed mitigation measures are insufficient
- A bypass would be required before any further development in Sproughton
- Do not want mini-roundabout in village
- The small decrease in the proposed number of houses does not change the overall impact the development will have on the area
- The Wild Man pub is now closed, leaving the village without yet another facility
- Public transport is infrequent, and there are not adequate and safe public footpaths or cycle routes in the area
- Exploitation of the ever changing NPPF and governments desire to increase housebuilding projects
- The junction on Main Street is already dangerous, and would be more so with an increase in traffic causing gridlock
- Sproughton is a known Rat Run and cannot cope with any more additional traffic from this proposed development, especially at times when the Orwell Bridge is shut
- Housing developments on brownfield sites should be prioritised
- Impact on property value
- Light pollution
- Not sustainable development
- Inappropriate in a Conservation Area [Officer note: the site is not within or near a conservation area]

Neutral comment based on:

- No assessment on the impact of increased traffic
- Lack of details for access to the development
- Supports additional road infrastructure to support traffic
- Further environmental and archaeology assessment required

(Note: All individual representations are counted and considered. Repeated and/or additional communication from a single individual will be counted as one representation.)

PLANNING HISTORY

REF: DC/18/02010

Full Planning Application. Residential development of 49 dwellings with new

DECISION: Pending

vehicular access from Bramford Road (B1113), associated parking, landscaping and open space.

REF: DC/18/02412

Full Planning Application (duplicate application of DC/18/02010)- Residential development of 49 dwellings with new vehicular access from Bramford Road (B1113), associated parking, landscaping and open space.

DECISION: Pending

REF: B//92/01028

ERECTION OF A STABLE/FIELD SHELTER AS AMENDED BY REVISED DRAWING RECEIVED 02.11.92

DECISION: Granted
16.11.1992

PART THREE – ASSESSMENT OF APPLICATION

1. The Site and Surroundings

- 1.1 The application site is located to the east side of Loraine Way (referred to as Bramford Road by the applicants) in the village of Sproughton. Sproughton is defined as a 'Hinterland Village' in the Babergh District Core Strategy 2014. The village settlement boundary aligns with the southern boundary of the application site.
- 1.2 The site comprises Grade 3 agricultural land, forming a meadow surrounded by hedgerows and interspersed vegetation on all boundaries. Part of the site is visible from Loraine Way, with the southern part of the site bounded by development along Loraine Way, Lower Street and most notably listed buildings forming Sproughton Hall and barns (Grade II), outbuildings and the Tithe Barn (Grade II).
- 1.3 To the east is Sproughton Hall, and the River Gipping, which is located around 30m from the site boundary with the intervening land mostly planted woodland. Adjoining the site to the south east and south of the site are dwellings and buildings that either front onto or are accessed via Lower Street. This includes Root Barn, Tithe Barn and Sproughton Community Shop. There are a number of properties along the southern boundary of this application site, which front onto Lower Street with rear gardens adjoining the application site, including the listed Walnut Cottage (Grade II). To the south west of the application site are further residential dwellings that face onto Loraine Way, again with rear gardens adjacent to the application site. Further along the west boundary of the site is intermittent hedgerow and mature trees. Further to the south west of the application site is the junction of Loraine Way/B1113 and Lower Street and Burstall Lane. The Wild Man Public House is located at this junction, which is a Grade II listed building. To the north of the site are fields predominantly used for grazing, with the listed building of Runcton House (Grade II) in Bramford around 400m from the site boundary.
- 1.4 The site is not in, adjoining or within proximity of a Conservation Area, but there are the listed buildings noted above and the following within the vicinity of the application site;- Mill House, Mill, Lower House and The Stores, nos 2 & 4 on Lower Street (all Grade II), and the Church of All Saints (Grade II*) and nos 1-4 Close, Church Lane (Grade II). There are also other listed buildings located further away, including Sproughton Manor and Grindle House (both Grade II).

- 1.5 The site is not within a Special Area of Conservation, but is within the Risk Impact Zone for the Stour and Orwell Estuaries Site of Special Scientific Interest (SSSI) Special Protection Area and Ramsar site. The site is also within a Special Landscape Area relating to the River Gipping, and covers the entirety of the application site. With regard to protected trees, there is one protected sycamore tree to the south of the site and a group of tree subject to a TPO outside of the site but directly adjoining the east boundary of the site.
- 1.6 The site is located directly adjoining the Built-Up Area Boundaries for Sproughton, and there are footpaths adjacent to Loraine Way and Lower Street that connect into the wider footpath network within Sproughton and to Bramford. There are no public rights of way through the site, but there is a public footpath located on the east side of the River Gipping within the vicinity of the site.
- 1.7 The boundary of both Bramford Parish and Mid Suffolk District Council are located approximately 25m to the north of this application site, running east to west. The site is also partly located within the Mineral Consultation Area. The proposed development and access road are located entirely within Flood Zone 1, with part of the site proposed for open space being within Flood Zones 2 and 3a.

2. The Proposal

2.1. The application is a Full application for 49 dwellings comprising of:

- 49 dwellings including 17 affordable dwellings (35%) located towards the north of the site
- open space including play area, and enhanced landscaping in and around site
- single vehicular and pedestrian access via B1113
- pedestrian footpath provision to Loraine Way and Lower Street
- market housing including; 13 no. two bed, 11 no. three bed and 8 no. four bed
- affordable housing including; 6 no. 1 bed, 9 no. 2 bed and 2 no. 3 bed
- mix of single storey bungalows, apartments, flats over garages and two storey dwellings
- single storey dwellings are located adjacent to the existing dwellings adjoining the site along Lower Street and Loraine Way.
- parking spaces for each dwelling meeting the required number under Suffolk Parking Standards for both cars and cycles.
- across the 3.45 hectare site a gross density of 14 dwellings per hectare (net density of 20 dph)
- materials of red, buff and multi bricks, render and weatherboarding. Proposed rooftiles include red and black pantile along with black Eternit slate.

3. The Principle Of Development

3.1 The starting point for any planning decision is the development plan, as identified in Section 38(6) of the Planning and Compulsory Purchase Act 2004. Determination of any application must be made in accordance with the plan unless material considerations indicate otherwise. A key material consideration regarding the principle of development is the National Planning Policy Framework (NPPF) 2019.

3.2 Paragraph 7 of the NPPF states that the purpose of the planning system is to contribute to the achievement of sustainable development. At paragraph 8, this is defined as meaning that there are three overarching objectives which are interdependent and need to be pursued in mutually supportive ways: economic, social, and environmental. The NPPF goes on to state, however, that they are not criteria against which every decision can or should be judged (para. 9).

3.3 Babergh benefits from a five plus year land supply position as required by paragraph 73 of the NPPF. However, paragraph 213 of the NPPF identifies that the weight attributed to policies should be according

to their degree of consistency with the NPPF. The closer the aims of the policy are to the NPPF the greater the weight that can be attributed to them.

Policy CS2 Settlement Pattern Policy

3.4 Policy CS2 (Settlement Pattern Policy) designates Sproughton as a Hinterland Village. Policy CS2 requires that outside of the settlement boundary, development will only be permitted in exceptional circumstances subject to a proven justified need. The site is outside the settlement boundary and policy CS2 therefore applies.

3.5 Policy CS2 has previously been found to be consistent with national policy, forming part of the Core Strategy as a post-2012 NPPF development plan document. It provides a strategy for the distribution of development that is appropriate in recognising local circumstances and its overall strategy remains sound. However, in the absence of an allocations document and settlement boundaries review (which has been absent for several years but has in practice been overtaken by the preparation of the emerging Joint Local Plan) it should be afforded less than full weight. This is also the case because national policy continues to require that policies are tested for their consistency with the NPPF: the 'exceptional circumstances' threshold is not entirely consistent with the NPPF and this has been recognised repeatedly in appeal decisions following the most recent NPPF publication. The fact that the site is outside the settlement boundary is therefore not necessarily a determinative factor upon which the application turns.

3.6 The NPPF does contain a not dissimilar exceptional circumstances test, set out at paragraph 79, however it is only engaged where development is isolated. For the reasons set out in this report, the development is not isolated. Paragraph 79 of the NPPF is not engaged.

3.7 A momentum in favour of securing development that satisfies the objectives of sustainable development, and the need for a balanced approach to decision making, are key threads to Policy CS1, CS11 and CS15 of the Core Strategy. Unlike Policy CS2, these policies are consistent with the NPPF, carry full statutory weight and provide the principal assessment framework as it applies to the subject application. Policy CS18 is also a key consideration given the scale of development proposed.

Policy CS1 Presumption in Favour of Sustainable Development

3.9 Policy CS1 takes a positive approach to new development that seeks to secure development that improves the economic, social and environmental conditions in the Babergh district.

Policy CS11 Strategy for Development in Core and Hinterland Villages

3.10 As noted in the Core Strategy, delivery of housing to meet the District's needs within the framework of the existing settlement pattern means there is a need for 'urban (edge) extensions' as well as locally appropriate levels of growth in the villages. Policy CS11 responds to this challenge, setting out the 'Strategy for Development in Core and Hinterland Villages'. The general purpose of Policy CS11 is to provide greater flexibility in the location of new housing development in the Core and Hinterland Villages.

3.11 The site is an edge-of-settlement location where the criteria set out at Policy CS11 are engaged.

3.12 Policy CS11 states that development in hinterland villages will be approved where proposals are able to demonstrate a close functional relationship to the existing settlement and where the following criteria are addressed to Council's satisfaction:

- (a) Core villages criteria:

- i) the landscape, environmental and heritage characteristics of the village;
 - ii) the locational context of the village and the proposed development (particularly the AONBs, Conservation Areas, and heritage assets);
 - iii) site location and sequential approach to site selection;
 - iv) locally identified need - housing and employment, and specific local needs such as affordable housing;
 - v) locally identified community needs; and
 - vi) cumulative impact of development in the area in respect of social, physical and environmental impacts.
- (b) Additional hinterland village criteria:
- i) is well designed and appropriate in size / scale, layout and character to its setting and to the village;
 - ii) is adjacent or well related to the existing pattern of development for that settlement;
 - iii) meets a proven local need, such as affordable housing or targeted market housing identified in an adopted community local plan / neighbourhood plan;
 - iv) supports local services and/or creates or expands employment opportunities; and
 - v) does not compromise the delivery of permitted or identified schemes in adopted community / village local plans within the same functional cluster.

3.13 The accompanying 'Rural Development & Core Strategy Policy CS11 Supplementary Planning Document' (the 'SPD') was adopted by the Council on 8 August 2014. The SPD was prepared to provide guidance on the interpretation and application of Policy CS11, acknowledging that the Site Allocations Document foreshadowed in Policy CS11 may not be prepared for some time. Although the SPD is not part of the statutory development plan, its preparation included a process of community consultation before it was adopted by the Council, and is considered to be a material consideration when planning applications are determined.

3.14 The matters listed in Policy CS11, which proposals for development for Hinterland Villages must address, are now considered in turn. Policy CS15 criteria, which an application must score positively against, are addressed later in this report.

The landscape, environmental and heritage characteristics of the village

Impact on Landscape

3.15 The NPPF emphasises as a core principle the need to proactively drive and support sustainable development to deliver homes. It states that both the intrinsic character and beauty of the countryside should be recognised and that pursuing sustainable development involves widening the choice of high quality homes. The planning system should contribute to and enhance the natural and local environment by protecting and enhancing valued landscapes.

3.16 Furthermore, policies CS11 and CS15 of the Core Strategy require development proposals to protect the landscape of the district, and local plan policy CR04 seeks to maintain or enhance the special landscape qualities of the area and designed and sited so as to harmonise with the landscape setting. The Planning Practice Guidance advises that '*The opportunity for high quality hard and soft landscaping design that helps to successfully integrate development into the wider environment should be carefully considered from the outset, to ensure it complements the architecture of the proposals and improves the overall quality of the townscape or landscape*'.

3.17 Policy CS11 envisages that there will be some development in the countryside and it is axiomatic that the development of a greenfield site will result in an element of adverse impact; the key question is

whether the character impact of the development is reasonably contained or can be mitigated to an acceptable degree.

3.18 A Landscape Visual Impact Assessment has been submitted with the application. This identifies the impact to both landscape character and visual receptors to the development. The most significant impacts by year 15 after completion of development include:

- Permanent moderate adverse impact to land use
- Minor adverse impact to character of Sproughton, Rolling Valley Farmland and Valley Meadowlands character areas and the Gipping Valley Special Landscape Area (SLA)
- Moderate adverse impact to listed buildings in vicinity (considered further in Heritage section below)
- Moderate adverse impact to users of Public Rights of Way around site, including PRow 22 – Gipping Valley River Walk
- Moderate/Minor adverse impact to motorists and pedestrians using Loraine Way
- Moderate adverse impact to residents of Loraine Way Road to west of site
- Major/Moderate adverse impact to residents of Lower Street to south of site (considered further in the Residential Amenity section to this report).

3.19 The scheme has also been designed to incorporate and enhance landscape features on the site. The sycamore tree subject to a Tree Protection Order to the south of the site is to be protected and retained, along with trees and hedges along the boundaries of the site. There are two lower category trees and landscape features, along with three portions of one hedgerow proposed to be removed on the site. Other than these all trees and hedges are to be retained, and provided works are carried out to the specification in the submitted arboricultural report there would be no adverse impact to trees retained on site. Additional trees and hedges are proposed to be planted on the site to strengthen existing landscape features. The Council's Arboricultural Officer raises no objections to the development.

3.20 The Council's landscape consultant also raises no objections to the scheme subject to conditions for further details on the soft and hard landscaping scheme.

3.21 The concern of coalescence between Sproughton and Bramford has been raised in letters of objection. The proposed development would represent a small incursion into the open landscape between Sproughton and Bramford, but it must also be noted that there are intervening landscape features such as trees and hedges that create a greater sense of separation between the two. In light of the small extent that the proposed development would extend into this landscape this is not considered to lead to a significant level of landscape harm.

3.22 The proposed development therefore is noted to have some landscape impact. The extent of this impact however would only lead to minor adverse impacts to the landscape character, but some moderate adverse impacts to visual receptors from surrounding public rights of way. The extent of these moderate adverse impacts has been considered, and also noted that they occur in a limited area in the context of the wider landscape. An appropriate landscaping scheme could be secured through condition to ensure a high standard of landscaping is provided, as required by local plan policy CR07, and it is not considered any hedges of amenity or landscape significance would be adversely affected by the small extent of removal proposed. The heritage and amenity impacts are considered further in the report. These impacts must be balanced against the benefits the scheme would deliver.

Impact on Heritage Assets

3.23 Section 66(1) of the Planning (Listed Buildings and Conservation Areas) Act 1990 ("the listed buildings Act") states: "in considering whether to grant planning permission for development which affects a listed building or its setting, the local planning authority ... shall have special regard to the desirability of preserving the building or its setting or any features of special architectural or historic interest which it

possesses" i.e. having special regard to the desirability of keeping designated assets from harm. Further to this local plan policy CN06 requires proposals for development within the setting of a listed building amongst other matters respect those features which contribute positively to the setting of a listed building, including space, views from and to the building and historic layout.

3.24 There are a number of listed buildings in the vicinity of the application site as noted above, but the heritage assets materially impacted by these proposals are considered to be Sproughton Hall, the Root Barn, the Tithe Barn and the Church of All Saints. Walnut Cottage has been considered, but the setting of this asset is not considered to be adversely affected by the proposed development, its significance being preserved. A Heritage Impact Assessment has been submitted with the applicant. On review of this assessment, the Council's Heritage Officer does not agree with the assessment of setting for many of the heritage assets, considering that the setting of some heritage assets incorporates more than just their physical location but also the functional relationship of buildings such as the Tithe Barn with the Church and Sproughton Hall. In conclusion the Council's Heritage Officer considers that there would be a medium level of less than substantial harm to the key heritage assets noted above due to the incursion of development into the previously undeveloped setting of these listed buildings, even with the revision of the scheme from 54 to 49 dwellings. Officers endorse this view. This harm, which warrants the attachment of considerable importance in line with the statutory duty referred to above, must be balanced against the public benefits of the scheme, as required under paragraph 196 of the NPPF. This is considered further in the Conclusion to this report. Within that balance great weight must be attached to the asset's conservation (and naturally considerable importance attached to any harm identified) in accordance with paragraph 193 of the NPPF, which is consistent with the aforementioned statutory duty. It is therefore said that where harm is identified there is an inherent presumption against planning permission being granted. It is possible to approve a development that is harmful to heritage assets but the benefits must be suitably compelling; this is a matter of judgement.

3.25 The site lies in an area of archaeological potential and the County Archaeologist requests an archaeological investigation condition should planning permission be granted. An archaeological evaluation including geophysical and trial trenching has already been undertaken. Archaeological features include a ring ditch likely to relate to the remains of a prehistoric burial mound, as well as Anglo Saxon and medieval ditches. There is considered to be high potential for below-ground heritage assets of archaeological importance, and groundworks associated with the development will destroy archaeological remains which are known to survive in the development area. However there are no grounds to consider refusal in order to achieve preservation in site of any important heritage assets. A condition is therefore recommended to record and advance understanding of the significance of any heritage assets before it is damaged or destroyed, to be in accordance with paragraph 199 of the NPPF.

The locational context of the village and the proposed development

3.26 Paragraph 10 of the SPD states proposals should be well related to the existing settlement and that the starting point for assessing this is whether or not the site adjoins the village settlement boundary. The SPD states a judgement will need to be made and issues to be taken account include:

- Whether the proposal would constitute ribbon development on the edge of the village
- How the site is connected to the existing settlement, jobs, facilities and services including location of site access and availability of sustainable transport links
- The scale, character and density of the proposal in relation to the existing adjoining development.
- Whether the proposal constitutes a logical extension of the built-up area of the village. Whether the proposal is self-contained and has logical, natural boundaries.

3.27 The site is very well related to the Sproughton settlement boundary, in part directly adjoining it and in other locations situated within very close proximity to it. The proposal would not constitute ribbon development given the proposed layout and depth of the site. The site is very well connected to the village in a visual sense, with residential development to the south of the site. The proposed scale and layout of development is not at odds with the form of neighbouring development along Lower Street and Loraine Way.

3.28 The site is in proximity to local village amenities including a community shop, primary school, public house and community facilities at the Tithe Barn. The proposed pedestrian access provides connectivity to bus stops (within 100m of centre of site) and the wider footway network. The catchment primary school is 0.4 miles from the site with a continuous footway link and secondary school 3.7 miles with no continuous footway/cycle link. It is accepted that trips beyond the village will be required for employment opportunities and supermarket shopping, to nearby locations such as Ipswich. Whilst it is accepted that the village is not well supported in terms of regular bus links, the village is in close proximity to Ipswich enabling people to cycle between Sproughton and Ipswich.

3.29 On balance it is concluded that the site has a functional relationship with the village and is in a sustainable location in respect of its access to local services and facilities.

Site location and sequential approach to site selection

3.30 The acceptability of the principle of development does not turn on whether or not the site is within the settlement boundary. There are no sites within the Sproughton settlement boundary which would enable a development of a scale or nature commensurate with that proposed. There is a large amount of brownfield land in Sproughton at the former Sugar Beet site, but this is allocated for employment uses and has recently been the subject of various planning permissions pursuant to that allocation and which remain extant or have already been implemented. There are no other brownfield sites being promoted for development within or around Sproughton of this scale. Case law, namely *R (on the application of East Bergholt PC) v Babergh DC* [2016] EWHC 3400 (Admin), has clarified that in relation to sequential assessment, there is no requirement to consider alternative sites adjoining the settlement boundary, as sequentially they are within the same tier. As a site abutting the settlement boundary, and bearing in mind its functional relationship with it, this criterion is satisfied.

Locally identified need - housing and employment, and specific local needs such as affordable housing

3.31 In respect of affordable housing need, paragraph 2.8.5 of the Core Strategy advises that Policy CS11 will lead to greater flexibility in the provision of affordable housing, related to need which has to be considered more widely than just within the context of an individual settlement but also the other villages within that cluster and in some cases adjoining clusters. This is consistent with the requirements of the NPPF that aim to ensure that the local plan meets the needs for affordable housing in the housing market area. Policy CS18 states that the mix, type and size of housing development will be expected to reflect established needs in the Babergh District. Policy CS19 also seeks to secure 35% affordable dwellings.

3.32 Paragraph 14 of the SPD states that proposals should be accompanied by a statement that analyses the local housing needs of the village and how they have been taken into account in the proposal.

3.33 The application is not supported by a full housing needs assessment, but does submit some evidence of surveys on local housing need, and meets the requirement of 35% affordable housing provided on site.

3.34 The Planning Statement submitted with the application identifies Sproughton Village Plan identified the following:

“...that there is a trend towards an older population with nearly 50% of the residents in the 25-59 year old age group. Some 22% have lived in the village for 6-15 years, 21% for 16-25 years and 23% for 25-50 years. Some 5% have lived in the village for their whole life.”

3.35 In addition to this the applicants sought views of the residents of Sproughton at their public exhibition on 20th September 2017 regarding what type of housing did people feel was needed in Sproughton. The responses were as follows:

Starter homes for young first-time buyers – 15 people agreed
Affordable Housing – 13 people agreed
5-bedroom houses – 1 person agreed
4-bedroom houses – 7 people agreed
3-bedroom houses – 12 people agreed
2-bedroom houses – 11 people agreed
1-bedroom houses – 5 people agreed
Bungalows – 14 people agreed

3.36 The mix of house sizes proposed under this application are:

Market housing including;
13 no. two bed (41%)
11 no. three bed (34%)
8 no. four bed (25%)
Affordable housing including;
6 no. 1 bed (35%)
9 no. 2 bed (53%)
2 no. 3 bed (12%)

3.37 Council's Strategic Housing Officer has identified the Strategic Housing Market Assessment specifies demand for new open market dwellings as follows:

Bed No's	Babergh DC
1	12%
2	36%
3	30%
4	22%

3.38 The Council's Suffolk wide Housing Needs Survey showed there was a need for small homes across all tenures, both for younger people who may be newly formed households but also for older people who are already own property but may wish to downsize. The Council's Housing Officer requests that a range of 2, 3 and 4 bedroom properties to include flats/apartments, terraced, semi-detached and detached houses, and bungalows where suitable.

3.39 The proposed market housing mix contains a significant number of 2 and 3 bedroom dwellings along with bungalows which is reflected in the information gathered at the above public consultation event. A range of properties including flats, terraced, semi-detached and detached houses and bungalows are also proposed on the site. Further to this the proposed affordable housing mix is in line with the required mix from the Council's Housing Officer. Some minor changes were made to the layout to address comments made by the Housing Officer, with an increase in the size of one of the shared ownership units and ensuring the affordable units were in more than one location on the site.

3.40 The identification of local housing need for the purpose of policy CS11 could be stronger with a full local housing needs assessment. However, on balance some evidence is submitted to allow an

assessment to be made against policy CS11. On balance it is considered that the proposed development would go some way to meet local housing need in relation to private market housing, and meet the requirements of affordable housing need.

3.41 Sproughton Parish Council have submitted a Housing Survey Report for Sproughton. The report produced by Community Action Suffolk aimed to understand the existing and future housing needs for Sproughton residents, including family members and other members of households (not necessarily living in Sproughton). A survey was sent to residents of Sproughton, and the key findings were that respondents favoured homes for older people, small family homes and homes for couples. In total, a response from 38 households identified a need for 87 people in Sproughton.

3.42 This housing survey identified the needs of residents in Sproughton. However, for the purposes of policy CS11, the policy approach set out in the Core Strategy relies on the concept that villages do not exist in isolation but part of wider functional clusters of villages. A local housing needs assessment for the purposes of policy CS11 requires that wider consideration of housing needs than just the parish level. Therefore the findings on the Housing Survey Report for Sproughton are noted, but the limitations of the report must be noted and conflict with this part of policy CS11 and in this respect it is not considered the application could be refused on the basis of this identified housing need.

Locally Identified Community Needs

3.43 The SPD states that proposals should be accompanied by a statement that assesses the community needs of the village and how they have been taken into account in the proposal. The application is not supported by a community needs assessment.

3.44 However, the development will generate contributions towards community infrastructure, to be spent on local services and infrastructure. The proposal would deliver benefits through CIL that are considered to satisfy this element of Policy CS11.

Cumulative impact of development in the area in respect of social, physical and environmental impacts

3.45 There is no evidence before officers, with the exception of highway impact addressed further below, to suggest the scheme will result in an unacceptable cumulative impact on the area in the context of social, physical or environmental impacts. There are no concerns raised by infrastructure providers and therefore the scheme does not result in an adverse cumulative impact on the area.

3.46 Any additional infrastructure requirements are a consequence of the development, they are not adverse social, physical or environmental impacts. Subject to mitigation where required, there are no grounds to reject the proposal because of any unacceptable adverse impact on local services and infrastructure. The proposal complies with this element of Policy CS11.

Development scale, layout and character

3.47 Local plan policies CN01 on design and CN04 on designing out crime are also key considerations. The character and layout of the proposed development is focused on the green space surrounding the development. The development seeks to provide a mix of dwellings and the entrance to the site has been well thought out, with a key feature of the site ensuring views are retained through to the Root Barn, Tithe Barn and All Saints Church. Development faces onto Loraine Way adjacent to the existing dwellings along Loraine Way. Development would back onto Loraine Way to the north of the proposed access into this development, but given the existing mature vegetation and trees it is considered an appropriate layout as retention of this vegetation is important in landscape terms. The scale of development has been

carefully considered, with a good proportion of bungalows incorporated, picking up on the nearby scale of development.

3.48 It is noted that plots 25-30 would lead to a larger building than others on the site. This has been considered for its acceptability. When viewing its location within the site and with surrounding vegetation, the building would be on the corner of the development. Given that this building would face onto an open space it is not considered to be overly-dominant within the wider scheme.

3.49 Detail on materials has been provided, and indicate materials of the local Suffolk vernacular. A condition is recommended to agree final materials, notwithstanding the details submitted, to ensure appropriate use of materials. A condition is also requested by the Council's Landscape Consultant to confirm hard landscaping details as there is some discrepancy between submitted plans.

3.50 The open space proposed on site would provide a sufficient level of open space as required by local plan policy HS31 Public Open Space and a play area, which would be secured through a Section 106 agreement.

Settlement context

3.51 As noted above, the site is well related to the village in visual and physical terms, consistent with this criterion.

Meets local need identified in neighbourhood plan

3.52 An area has been designated for Sproughton Neighbourhood Plan but this has not reached the stage of a draft neighbourhood plan at present.

Supports local services and/or creates employment opportunities

3.53 The development of 49 dwellings would create short term employment opportunities. The future residents of these dwellings would also support local services in the village (and naturally, consistent with the NPPF and the Functional Cluster model within the Core Strategy, support services and facilitates within settlements nearby).

Delivery of permitted schemes

3.54 There is no evidence before the Council that the proposal would compromise the delivery of other permitted schemes in the village.

Policy CS15 Sustainable Development

3.55 Policy CS15 sets out how the Council will seek to implement sustainable development. A number of criterion set out at CS15 have already been considered in this report, those that have not are considered further below.

3.56 Policy CS15 seeks to minimise the need to travel by car using alternative means and improving air quality. The site is well connected in highway connectivity terms. As acknowledged above, the proposal will generate vehicle trips for travel to employment and other services such as food shopping not provided in the village. This said, as noted above, the village has many of the day to day services expected in a hinterland village of this size. Employment opportunities are available in nearby Ipswich.

3.57 Policy CS15 sets out criteria relating to economic benefits, supporting local services, sustainable design, and creation of green spaces, minimising waste and surface water run-off and promotion of healthy living, along with Policy CS14 on green infrastructure. Further to this paragraph 78 of the NPPF identifies that to promote sustainable development in rural areas, housing should be located where it will enhance or maintain the vitality of rural communities, and paragraph 79 seeks to avoid the development of isolated homes in the countryside. The proposal respond favourably to these matters.

3.58 A Phase 1 Desktop Contamination Report supports the application. Environmental Health raise no objection to the proposed development from the perspective of land contamination. The proposal complies with criterion vii of Policy CS15 insofar as it relates to land contamination.

4. Site Access, Parking And Highway Safety Considerations

4.1. Paragraph 109 of the NPPF states that development may be prevented or refused on highway grounds where there would be an unacceptable impact on highway safety, or the residual cumulative impacts on the road network would be severe. The proposed development has been considered in terms of impact on the wider road network through the Transport Assessment submitted with the application. The site access via Loraine Way and impact on the wider road network have been considered to road capacity and highway safety. Paragraph 111 of the NPPF also seeks Travel Plans for development that generate significant amounts of movements.

Impact on wider network

4.2 The Transport Assessment submitted with the planning application assessed the likely impact of vehicular traffic associated with the proposed development. Traffic modelling was undertaken to consider the impact of this development and trip generation on key local junctions using recent traffic survey data. Both the individual and cumulative impacts of this development with other surrounding planning applications has been considered. These applications included the following applications and sites:

- 18/00233 land east of Loraine Way, Bramford (195 dwellings and pre-school)
- 19/00567 land north of Burstall Lane, Sproughton (114 dwellings, community use)
- B/15/00993 at land north and south of Poplar Lane, Sproughton (620 dwellings, employment and commercial uses and other associated infrastructure)
- 19/01401 - land south of Fitzgerald Road, Bramford (115 dwellings)

4.3 The Highway Authority carried out analysis of the applications Transport Assessments/Statements for the above planning applications. This identified the potential for cumulative highway impacts from all potential development sites coming forward, in particular there are significant/potentially severe delays at key junctions of Loraine Way/Lower Street/Burstall Road in Sproughton. Subsequent discussions were held with the developers of the above sites to consider how the identified cumulative highway impacts could be mitigated.

4.4 A series of improvements have been identified by the Highway Authority for all of the above schemes to contribute proportionally to, to address the cumulative highway impacts. These will be secured via Section 106 contributions from each developer. These include:

- A1071/B1113 Beagle Roundabout – junction improvements to widen approach lanes to roundabout
- New zebra crossing on B1113 to the north of Wild Man Public House
- B1113/Burstall Lane – reduce kerb radii and install uncontrolled pedestrian crossing
- New cycle link between Sproughton and Bramford – cycle link on Loraine Way/footway improvements

4.5 The above improvements require all developments to come forward to enable the full cost of the works to be secured. It has been considered what would happen if one scheme were to stall or to not come forward. In this instance some improvements could still be carried out for example on the Beagle Roundabout. In this instance the roundabout widening could be delivered by the first development, and signals/widening delivered by later sites. If insufficient funds were secured to deliver the zebra crossing or uncontrolled pedestrian crossing on the B1113, the funds that have been collected from commenced developments would be put towards delivering the new cycle link between Sproughton and Bramford. This is considered to adequately mitigate the highway impact for this proposed scheme.

4.6 Members may also wish to note within the vicinity of this application site the following improvements would be secured if the following planning applications were granted permission and constructed. Planning application 19/00567 at land north of Burstall Lane, Sproughton would provide a new priority junction with right hand turning land on the B1113 at the proposed access to site if it were approved. This would be required to mitigate the direct impacts of the development of that application, and so it is not reasonable to require this application currently being considered by Members to contribute to these.

4.7 Through the work to consider the cumulative impact of proposed development in the vicinity of this application site, two application sites in Barham and Claydon were also considered. These were 18/00861 for 73 dwellings on land at Ely Road in Barham and Claydon, and land east of Norwich Road in Barham for 269 dwellings. These were considered but there was not considered to be a cumulative impact with this application site currently being considered by Members as they are too geographically detached, most notably by the A14, for traffic from those developments to impact roads and junctions around this application site.

4.8 Whilst the applicant identifies their scheme would only have a minimal impact, they do have an impact in conjunction with existing road capacity and proposed developments in the area. It is therefore considered reasonable to secure the above mitigation measures. With these two junctions and the identified mitigation measures the highway impact would only be approaching capacity and not a severe adverse highway impact, as is the test under paragraph 109 of the NPPF.

4.9 Highways England have been consulted and raised no objection in terms of the impact on the trunk road A14 and its junctions in the vicinity of the application site.

On site access and other highways matters

4.10 The application seeks detailed consent for the access point on Loraine Way. The proposed junctions has been designed to an acceptable level with appropriate visibility splays which are to be secured through planning condition. Accident data has been reviewed and there are no patterns and no sections of highway where the layout or design has resulted in collisions in the last five years.

4.11 Saved Policy TP15 of the Local Plan seeks to ensure parking provision for new development complies with the Suffolk Parking Standards. This development plan policy is given full weight as it is considered to align with paragraphs 105 and 106 of the NPPF in providing minimum parking space standards unless compelling reasons justify otherwise. The site layout plan shows parking and garage spaces can be provided for each dwelling. The number of parking spaces within the development, meets the minimum requirements. There are 4 visitor car parking spaces identified out of a suggested 12 under the above parking standards, but it is considered that there is sufficient space on site for visitor parking. The Highway Authority have raised no objection to the parking proposed, subject to a condition to secure parking (including electric vehicle charging points). The development complies with local plan policy TP15.

4.12 Sufficient cycle parking for two cycles per dwelling plus visitor cycle parking could be provided within garages of houses/bungalows or through covered and secure storage units in rear gardens of flats. Also refuse bins could be stored in rear gardens, with refuse storage and collection areas being agreed through condition.

4.13 The Highway Authority have raised no objections subject to the mitigation measures and details to be secured through the S106 and proposed conditions below. Also CIL monies totalling £5,000 will be sought to improve bus stops to make them more accessible for wheelchairs/pushchairs and install bus shelters. With the proposed mitigation through S106 agreement and conditions, the development is considered to meet the requirements of both paragraphs 109 and 111 of the NPPF and policy T15 of the local plan ensuring there is not a severe impact on the road network, provision of safe access and egress from the site, the safe and free flow of traffic and pedestrian safety, suitable capacity in the road network, adequate parking and turning for cars and service vehicles and pedestrian and cycle links.

5. Ecology, Biodiversity And Protected Species

5.1 Policy CS15 of the Core Strategy seeks to protect and enhance biodiversity. These requirements are considered to be supported by the relevant paragraphs in the NPPF, including 170 on minimising impacts on and providing net gains for biodiversity, 175 which seeks to avoid, mitigate, or compensate for adverse impacts or lastly refusing harmful development, and looking for opportunities to incorporate biodiversity improvements in and around developments should be encouraged, especially where this can secure measurable net gains for biodiversity. Therefore the above development policies are considered to carry full weight. Also Regulation 9(3) of the *Conservation of Habitats and Species Regulations 2017* requires all 'competent authorities' (public bodies) to have regard to the requirements of the Directive. For a Local Planning Authority to comply with regulation 9(3) it must engage with the provisions of the Habitats Directive.

5.2 An initial Phase 2 Ecology Survey and Assessment was submitted with the application. The report was been reviewed by Council's Ecology Consultant who agreed with the report's findings relating to bats, nesting birds, reptiles, hedgehogs and potential invertebrates such as Stag Beetles that could use the site. A number of enhancement measures were identified including native planting on site with species known to benefit bats, provision of bat bricks/boxes, bird nesting boxes, maintenance of reptile friendly habitats, hibernacula/log piles and bug boxes. The biodiversity enhancement measures recommended in the ecology report could be secured by planning condition and will result in a net gain for biodiversity on the site. The recent reconsultation on the application identified that the ecology reports are now out-of-date and require updating. At the time of writing the committee report the applicants were addressing this point, and an update will be given to Members at the committee meeting on this matter.

5.3 The site lies within 13km of the Stour and Orwell Estuaries SPA and Ramsar site which could lead to likely significant effects to this protected site. However as the proposal is now for under 50 dwellings a Stage 2 Habitats Regulations Assessment is not required, but a proportional financial contribution would be required to provide mitigation to protect this site from additional recreational disturbance. With this contribution it can be concluded that this application will not have an adverse effect on the integrity of the above sites from recreational disturbance. The requirements of the Conservation of Habitats and Species Regulations 2017 are therefore considered able to be met.

6. Flooding and Surface Water

6.1 Criteria xi and xii of saved Policy CS15 requires development to minimise the exposure of people and property to all sources of flooding and to minimise surface water run-off and incorporate sustainable drainage systems (SUDS), where appropriate. Paragraph 150 of the NPPF seeks to avoid increasing vulnerability to impacts of climate change, with development needing to demonstrate it does not increase

flood risk elsewhere. Paragraph 170 of the NPPF also seeks to ensure new development does not contribute to water pollution, and as this site is over a Principal Aquifer and in a Nitrate Vulnerable Zone so the water quality of surface water run-off is a key issue.

6.2 The application is accompanied by a flood risk assessment (FRA). The site is predominantly in Flood Zone 1, with all built form within this lower risk flood zone. A section of the open space and path through this space is in Flood Zones 2, 3a and 3b when taking climate change into account. The sequential test is therefore triggered under paragraph 155 and 157 of the NPPF as part of the site is in this higher risk flood zone. This test seeks to identify whether development could be sited in a lower risk flood zone.

6.3 As no development aside from a footpath is proposed in these higher risk flood zones however, a pragmatic approach is suggested towards the sequential test. The risk of flooding towards people and property is low as the open space would be the area of the site that would flood. Therefore whilst the sequential test is triggered, officers place less weight on this conflict with the material consideration of the NPPF as there would not be a risk of flooding to the proposed development on site and residential occupants, and there is not considered to be an increased risk of flooding elsewhere as a result of the development (subject to suitable mitigation).

6.4 The Environment Agency (EA) have been consulted on the application, and whilst they offer no objection they have advised the council must take account of flood risk. The EA also note in their subsequent response that the site is sequentially sited away from higher flood risk, and the built footprint is in Flood Zone 1 with safe access and egress.

6.5 Core Strategy policy CS15 seeks to minimise the exposure of people and property to the risks of flooding by taking a sequential risk-based approach. As detailed above, the proposals would not increase the risk of flooding to people and property as no built form is proposed outside of flood zone 1. The proposal therefore does not conflict with policy CS15 in this regard, but the conflict with paragraph 157 of the NPPF is noted. However, and even if at a strict interpretation policy CS15 is also breached, as the proposed development would only site part of the open space within the higher risk flood zones, and would not lead to an increase risk of flooding to people or property, it is not considered refusing the development on this ground would be reasonable or a reason that would successfully withstand appeal.

6.6 With regard to surface water, disposal via infiltration is considered feasible, with the site capable of managing storm water in the 1-in-100 year flood event (with 40% climate change allowance) and appropriate pollution control mechanisms provided.

6.7 Anglian Water have indicated they have capacity for wastewater treatment but a drainage strategy is requested via condition to ensure there is appropriate foul sewerage network capacity.

6.8 The application is therefore considered to be acceptable in relation to matters of flooding and drainage.

7. Impact On Residential Amenity

7.1 Paragraph 127 of the NPPF sets out a number of core planning principles as to underpin decision-taking, including, seeking to secure a high standard of amenity for all existing and future occupants of land and buildings.

7.2 The majority of proposed dwellings are set well back from the existing neighbouring residents, although it should be noted that plots 9 and 10 are the closest to neighbouring dwellings on Lower Street. The orientation of the dwellings should also be taken into account, with dwellings on Lower Street to the south of the development site which would limit the loss of daylight and direct sunlight from the proposed

development. The distance from the rear of the proposed dwelling to the neighbouring property is around 20m. The proposed garage would be at around 10m from the neighbouring property. The corner of proposed plot 7 would also be around 10m from the boundary of the dwelling in the former Police House on Loraine Way. Whilst these distances are close, the proposed dwellings in plots 4 to 10 are single storey. Therefore the level of outlook, daylight and direct sunlight would not be sufficiently adversely affected to merit refusal of the application on this basis.

7.3 The proposed public footpath adjacent to the Cardinals and Forge House linking the south west of the application site to Loraine Way has been considered in terms of residential amenity. Both properties currently have ground floor windows facing the piece of land that is proposed to become the footpath. The area is currently covered by vegetation, with a fence on one side. The proposals indicate a 1.8m fence to run either side of this footpath. The loss of outlook and disturbance from this area becoming publicly accessible has been considered. Whilst it is regrettable that there would be some loss of amenity for these residents, the benefits of providing this link to facilities such as the nearest bus stop have been balanced against this harm. In this instance it is considered that the loss of amenity for these residents is not sufficient enough to merit refusal of the scheme on this basis.

7.4 The wider impact of introducing development to the rear of resident's properties where they have previously not had such a use has been considered. The development would lead to some loss of amenity from noise associated with residential dwellings and loss of privacy from the two storey dwellings located further within the site. Both of these however are considered to be to a minimal degree due to the design and layout of the scheme, and not sufficient reason for refusal.

7.5 Concerns have also been raised over air quality for residents from the additional traffic associated with this development. Environmental Health have considered the application but do not raised an objection based on air quality.

7.6 The amenity of future residents of the site has also been considered. There is sufficient space between dwellings and appropriate orientation of dwellings to ensure an adequate level of amenity in relation to outlook, privacy, daylight and sunlight will be achieved for future residents. Each dwelling has access to private amenity space and a large area of public amenity space. The proposed flats have a small outdoor private amenity space but each flat has a covered balcony area that can be used for private amenity. The amenity for future residents is therefore considered to be acceptable and in line with paragraph 127 of the NPPF.

8. Delivery

8.1 The NPPF makes clear in paragraph 59 that it is the Government's intention to significantly boost the supply of housing and in support of that objective it is important that a sufficient amount and variety of land can come forward where it is needed, that the needs of groups with specific housing requirements are addressed and that land with permission is developed without unnecessary delay. Paragraph 76 of the NPPF also states that in order to help ensure proposals for housing developments are implemented in a timely manner, a shorter time limit can be considered, provided it does not affect its deliverability or viability.

8.2 The deliverability of a development is an important factor in an assessment as to its sustainability (in terms of its benefits) and in terms of its contribution to the supply of housing in the District; considered to be more compelling in the event that there is a demonstrable shortfall in housing supply.

8.3 The NPPF defines deliverable:

“To be considered deliverable, sites for housing should be available now, offer a suitable location for development now, and be achievable with a realistic prospect that housing will be delivered on the site within five years.”

and:

“Sites with outline planning permission... should only be considered deliverable where there is clear evidence that housing completions will begin on site within five years.”

8.4 The PPG gives further guidance on those considerations under the chapter heading, ‘*Housing and economic land availability assessment*’ and including three, important concepts: *suitability*, *availability*, and *achievability*. Whilst primarily aimed at aiding the plan-making process, the principles are no less useful when considering the deliverability of this development. The PPG also identifies information relating to site viability, ownership constraints or infrastructure provision, and a statement of common ground between the local planning authority and the developer confirming the anticipated build-out rates.

8.5 A shorter time limit of two years to implement has been discussed with the applicants to ensure the dwellings would come forward in a timely manner and support delivery towards the council’s five year housing supply.

9. Other matters

9.1 The Best and Most Versatile (BMV) agricultural land is sought to be retained under paragraph 170 of the NPPF. In this instance the 3.45ha comprises of Grade 3 land. It is not known whether this is Grade 3a (Best and Most Versatile) or 3b which does not fall into BMV. Given the small size of the site it is not considered reasonable to ask the applicants to ascertain the grade. The extent of loss of 3.45ha would be minimal to the wider agricultural land available and so would not be sufficient to merit a reason for refusal for this development.

9.2 The site partly lies within the mineral consultation area under Suffolk County Council’s Mineral Core Strategy 2008. Policy 5 of this document requires that any proposed development on unallocated sites over one hectare will be safeguarded from development unless it can be shown that sand and gravel present are no of economic value or that mineral will be worked prior to development taking place. This is considered to align with paragraphs 203 and 204 of the NPPF, and so can be given full weight.

9.3 The Mineral Planning Authority have responded with no objection but requesting an assessment of minerals resource is conducted, if materials are found a strategy should be formed on how the resource is to be used which can be conditioned as part of any permission. If material is economically viable prior extraction or use on site should be considered. With this condition the proposed development would therefore be in accordance with paragraph 203 and 204 of the NPPF.

9.4 Section 143 of the Localism Act 2011 on local financial considerations requires consideration to be given to the financial benefits a development would bring to the council through grant income, such as New Homes Bonus, Community Infrastructure Levy, Council Tax and Business Rates. Whilst such considerations are positive they should be afforded little weight; the PPG is clear that it is not appropriate to make a decision based on the potential for the development to raise money for a local authority or other government body. Officers do not consider that such benefits are determinative in reaching the recommendation at the end of this report.

9.5 Fire hydrants would be conditioned to any approval issued.

9.6 It is noted that Suffolk County Council request some housing on site is housing with care for older people. A mix of housing is proposed on the application site, but none specifically for older people. In the absence of a clear policy requirement for housing for older people in the development plan it is not possible to insist it is provided.

9.7 Superfast Broadband connections are also requested by the County and provision supported by paragraph 112 of the NPPF. This is a service provided by a private company and so cannot in itself be secured through planning consent. A condition can be applied to ensure there is sufficient space for the required cabling to each dwelling within the development and is recommended as such.

9.8 The development would be required to be built to sustainable design and construction standards and with renewable/low carbon energy sources under policies CS12 and CS13 of the core strategy. However, the Written Ministerial Statement on Housing Standards (reference HCWS488) made in 25th March 2015 is clear that requirements should not be set over revised Building Regulations Part L1A and Part G that came into force in 2015. Meeting revised Building Regulations is considered to provide a good standard of construction, carbon dioxide emissions rate, energy performance of buildings and reduced water usage of 125 litre of water per person per day. With the required compliance with Building Regulations the proposed development is considered to meet the requirements of paragraph 150 of the NPPF which seeks to reduce greenhouse gas emissions. A condition is recommended for a Sustainability and Energy Statement to detail the measures to be taken.

10. Planning Obligations / CIL

10.1 As required by various policies listed in the above report and policy CS21 of the core strategy, the application, if approved, would require the completion of a S106 agreement to secure the required number of affordable dwellings, along with mix and tenure, the provision of open space, the RAMs contribution and highway mitigation measures identified earlier in the report.

10.2 CIL contributions would be sought for primary school expansion of £182,556, secondary school place provision of £181,904, Sixth Form expansion of £45,476, £10,584 for libraries and £5,390 for waste infrastructure.

11. Emerging Joint Local Plan

Emerging Joint Local Plan

11.1 The Joint Local Plan (JLP) Preferred Options Regulation 18 was published in July 2019. In this document this site was promoted for development by the landowner/developer but it was not proposed to be allocated.

11.2 This JLP is at present at an early stage in the plan making process, and so limited weight can be given to this document in terms of deciding this planning application. This does however give an indication of the direction of travel as to how the authority will meet it identified housing needs over the next plan period with planned infrastructure to support this growth.

11.3 The above report however indicates that the different infrastructure requirements for the proposed development can be provided. There is no reason to refuse the application on this basis. Whilst the underlying evidence to support the emerging JLP is extensive and a material consideration, there is no evidence to suggest this development would undermine the wider infrastructure delivery for the JLP. Members must have caution in placing weight on the fact the site is not allocated in the JLP as the plan is at an early stage.

PART FOUR – CONCLUSION

11.1 The Council benefits from a five-year housing land supply. The tilted balance at paragraph 11(d) of the NPPF is not engaged in that respect.

11.2 The site is outside the settlement boundary and therefore conflicts with Policy CS2. As a policy of vital importance underpinning the spatial strategy of the Council, and where the circumstances of this application are not exceptional, the development is considered to conflict with the development plan as a whole. It is then important to consider whether other material considerations indicate that a decision other than in accordance with the development plan should be made.

11.3 Policy CS2 carries reduced statutory weight because of the age of the settlement boundaries and its inconsistency with the NPPF, although the overall settlement pattern strategy remains sound. Bearing in mind the relationship between the site and the settlement of Sproughton as a Hinterland Village, the underlying aims of policy CS2 are broadly met. Policies CS1, CS11 and CS15 are attached full statutory weight given their strong alignment with the NPPF. Therefore for the purposes of paragraph 11(d) the policies most important for determining the application as a whole are considered to be up-to-date. Whilst CS2 carries some reduced statutory weight, as a complement of policies they are not considered to be out-of-date and paragraph 11(d) is not engaged in that respect.

11.3 Although the site is located outside the main part of Sproughton, it is on the edge of the village, close to other development. Policy CS11 contemplates development at such edge-of-village locations. The land is in a sustainable location, with pedestrian connectivity. The proposal would not be physically, visually or functionally isolated. The site's sustainable location is a scheme positive.

11.4 The applicant has not fully demonstrated how the dwellings serve an identified local need. Some information has been collated however and on balance this provides sufficient information to conclude that the development does go some way to meet local housing need for market housing. The Parish Council's Housing Survey Report identified limited need for additional housing, but it must be considered that the report does not cover the local housing need from the functional cluster of villages around Sproughton as required under policy CS11 of the Core Strategy and so can only be given very limited weight. The proposal offers 35% affordable housing provision which is policy compliant.

11.5 The proposal will result in a medium level of less than substantial harm to the setting of the neighbouring Grade II listed buildings and Grade II* listed Church. This harm to the designated heritage assets is a disbenefit of the scheme which needs to be treated with the utmost importance in light of the statutory duties imposed by the listed building Act.

11.6 In determining this application Officers are mindful of the specific duty imposed on the local planning authority with respect to the need to have special regard to the desirability of preserving the listed building or its setting, as set out in section 66 of the Planning (Listed Buildings and Conservation Areas) Act 1990. Full consideration has been given to the comments received from the Heritage Team. The level of harm to the above Grade II and Grade II* listed heritage assets is noted to be a medium level of less than substantial harm.

11.7 Paragraph 192 of the NPPF states that in determining planning applications, local planning authorities should take account of:

- the desirability of sustaining and enhancing the significance of heritage assets and putting them to viable uses consistent with their conservation;

- the positive contribution that conservation of heritage assets can make to sustainable communities including their economic vitality; and
- the desirability of new development making a positive contribution to local character and distinctiveness.

11.8 Further to this paragraph 193 of the NPPF identifies “when considering the impact of a proposed development on the significance of a designated heritage asset, great weight should be given to the asset’s conservation.” It continues to identify that “This is irrespective of whether any potential harm amounts to substantial harm, total loss or less than substantial harm to its significance.”

11.8 Paragraph 196 of the NPPF states that where a development proposal will lead to less than substantial harm to the significance of a designated heritage asset, this harm should be weighed against the public benefits of the proposal. In consideration of the contribution towards the Council’s housing targets, provision of affordable housing and economic and infrastructure benefits and biodiversity net gain, it is considered that these material considerations would none the less outweigh the medium level of less than substantial harm to the heritage assets, even where a considerable importance and great weight is applied to the desire to keep the affected asset from harm.

11.9 Officers have therefore applied the balance required by paragraph 196 of the NPPF, having special regard to the desirability of preserving the setting of the listed building as required by section 66 of the listed buildings Act and given the harm considerable importance and weight. The outcome of this balancing exercise is that those public benefits including housing, policy compliant affordable housing provision, an accessible location reducing the need to travel by private car compared to more remote areas of the district and net gain for ecology and biodiversity on the site, are considered to outweigh the medium level of less than substantial harm, having given considerable importance and weight to the harm identified. With regard to the duty under the 1990 Act, the heritage harm of medium level of less than substantial harm to heritage assets has been identified and harm against local plan policy CN06 noted, and then balanced against the public benefits of the scheme as required by paragraph 196 of the NPPF. For the avoidance of doubt, officers have also had special regard to the desirability of preserving the setting of the identified listed buildings as required by the above Act, but in this instance do not consider planning permission should be refused on the basis of the identified harm to the setting of the listed building. It is considered the duties under the above Act have been met in coming to the conclusion.

11.10 The starting point for decision-taking purposes remains the development plan with the National Planning Policy Framework a material consideration in this decision. The policies of the Core Strategy generally conform with the aims of the Framework to promote sustainable transport through walking, cycling and public transport by actively managing patterns of growth in support of this, whereby significant development should be focused on locations which are or can be made sustainable, through limiting the need to travel and offering a genuine choice of transport modes.

11.11 However, the Framework objectives for sustainable development include delivering a sufficient supply of homes. The council can demonstrate at least the five-year housing land supply required by paragraph 73 of the Framework. Therefore, there are not the grounds on which to find policies as out of date in respect of housing supply and so it is not necessary to apply the ‘tilted balance’ of Framework paragraph 11 in that respect.

11.12 Nevertheless, meeting the requirements of paragraph 73 is not intended as a ceiling on further housing, where the Framework continues to support Government’s objective to significantly boost the supply of homes under paragraph 59 of the NPPF. The location is considered to be a sustainable location with some services provided within the village and good connections to Ipswich reducing the need to travel by private car.

11.13 Although there would be some degree of harm through this proposal running contrary to the adopted settlement strategy of the Core Strategy, this would be off-set by the national policy considerations set out above. The Framework recognises in paragraph 68 that small and medium-sized sites can make an important contribution to meeting the requirement of an area, and are often built-out relatively quickly. There is also some degree of conflict with Core Strategy policy CS15 as more information could have been provided on local housing need, and paragraph 157 of the NPPF relating to flood risk although this is largely mitigated by no increase in risk of flooding to people or property as all built form is in Flood Zone 1.

11.14 As identified above in the report, the development would result in an impact on the landscape character and to visual receptors to the site. However, the landscape harms identified would reduce to moderate adverse with mitigatory planting by year 15 of the development being completed. The extent of these harms must also be noted, and that they do not occur over a significantly large area within the wider landscape. There would not be significant harm to the Special Landscape Area either. The site is physically very well related to the body of the village. Whilst the urbanising effect will be marked, the development will not appear isolated in a landscape sense (and paragraph 79 of the NPPF is not engaged). The development scale will not overwhelm the village given its size and sufficient provision can be made for required infrastructure.

11.15 The proposal would result in the development of 49 new dwellings, which would add to the local housing stock and offer meaningful support for the local services in the village, both during construction and following occupation of the development. Consequently, the proposal would have social and economic benefits that, given the scale of development proposed, which would be significant. These benefits are afforded more than moderate weight given the level of contribution towards the aim of achieving sustainable development. They weigh clearly in favour of the scheme.

11.16 Having regard to the comments of the highway authority, it is concluded that the proposal would not be detrimental to highway safety. Residential amenity of neighbours is safeguarded to an acceptable level and a high standard of amenity will be provided for future occupants of the development. Finally the development would enable a net gain for biodiversity compared to the existing value of the site for protected species. These are scheme positives.

11.17 Therefore, it is considered the above merits of the scheme and broad compliance with policy CS15, including the accessible location of the housing and its contribution to boost housing supply, when balanced against the medium level of less than substantial harm to heritage assets, limited harm to the wider landscape and loss of agricultural land, and would represent sustainable development and when considered as a whole would meet the requirements of policy CS15 and all other relevant local plan policies outlined above. The conflict with policy CS2 on the location of this development is noted, but is given less weight for the reasons outlined above. Matters relating to heritage, landscape and local housing need have been considered, but for the reasons identified in the above report these matters are considered not to be fatal to the application, and the proposal is considered to broadly comply with policy CS11. The proposal is considered to represent an appropriate site for new residential development and would deliver sustainable development, furthering the overarching thrust of policies CS1 and CS15 of the Core Strategy and providing for net gains to the three objectives of sustainability in accordance with the NPPF (which notwithstanding the development plan is a compelling material consideration). The application is therefore recommended for approval because, although not in compliance with the development plan as a whole other, material considerations indicate that permission should be granted and this is considered to be the appropriate outcome.

RECOMMENDATION

That the applications are GRANTED planning permission and includes the following conditions:-

(1) Subject to the prior agreement of a Section 106 Planning Obligation on appropriate terms to the satisfaction of the Chief Planning Officer to secure:

- Affordable housing – no less than 17 dwellings (35% of total scheme)
 - Properties shall be built to current Housing Standards Technical requirements March 2015 Level 1. All ground floor 1 bed flats to be fitted with level access showers, not baths.
 - The council is granted 100% nomination rights to all the affordable units on initial lets and 75% on subsequent lets
 - All affordable units to be transferred freehold to one of the Councils preferred Registered providers.
 - Adequate parking provision is made for the affordable housing units including cycle storage for all units.
 - Commuted sum option available to be paid instead of on site provision should the LPA agree to such request.
- On site open space and playspace (to include natural play equipment) and include management of the space to be agreed and requirement for public access at all times.
- RAMS contribution
- Highway improvement works contributions to include:
 - B1113 - New zebra crossing north of Wild Man PH access - £15,050
 - B1113/Burstall Lane/Lower Street Junction – Reduce kerb radii and install uncontrolled crossing points
 - A1071/B1113 Beagle Roundabout – Widening of approach lanes to roundabout - £5,050
 - Footway between Sproughton and Bramford – Cycle link on Loraine Way - £25,050

(2) That the Chief Planning Officer be authorised to APPROVE Planning Permissions upon completion of the legal agreement subject to conditions as summarised below and those as may be deemed necessary by the Chief Planning Officer:

- Time limit (reduced to 2 years)
- Approved Plans (Plans submitted that form this application)
- Phasing Condition (To allow phasing of the development and allows spreading of payments under CIL)
- Market housing mix prior to or concurrent with reserved matters to be agreed
- Provision of visibility splays
- Details of access
- Details of estate roads and footpaths
- Provision of carriageways and footways to binder course level prior to occupation
- Construction management plan
- Discharge of surface water from highway
- Residents travel pack
- Manoeuvring and parking details

- Refuse/cycling bin details
- Level access to enable wheelchair access for all dwellings/buildings.
- Fire hydrant provision
- Energy, renewable integration and sustainability measures (including rainwater harvesting)
- Biodiversity method statement
- Biodiversity enhancement strategy, including swift boxes and hedgehog fencing
- Landscape and ecological management plan
- Wildlife sensitive lighting design scheme
- Archaeology: Written scheme of investigation
- Archaeology: Site investigation and post investigation assessment
- Surface water disposal strategy
- Sustainable Urban Drainage System components and piped network details
- Construction Surface Water Management Plan
- Hours of work for construction/demolition, construction method statement (control of noise, dust, light, no burning of waste, hours of construction) and no burning of waste
- Hard and soft landscaping scheme
- Landscape management plan
- Foul water strategy
- Surface water management strategy (Anglian Water)
- Unknown contamination
- Final materials to be agreed
- Minerals extracted from site quantified
- Broadband cable ducting provided

(3) And the following informative notes as summarised and those as may be deemed necessary:

- Proactive working statement
- SCC Highways notes
- Support for sustainable development principles
- Archaeology
- Surface water

(4) That in the event of the Planning obligations or requirements referred to in Resolution (1) above not being secured and/or not secured within 6 months that the Chief Planning Officer be authorised to refuse the applications on appropriate ground(s).

BABERGH DISTRICT COUNCIL

Minutes of the meeting of the **PLANNING COMMITTEE** held in the Grand Hall, Hadleigh Town Hall, The Guildhall, Market Place, Hadleigh, Suffolk, IP7 5DN on Wednesday, 17 April 2019 09:30

PRESENT:

Councillor: Peter Beer (Chair)
Michael Holt (Vice-Chair)

Councillors:	Clive Arthey	David Busby
	Michael Creffield	Luke Cresswell
	Alan Ferguson	Jennie Jenkins
	Adrian Osborne	Lee Parker
	Stephen Plumb	David Rose
	Ray Smith	

Ward Member(s):

Councillors: Nick Ridley

In attendance:

Officers: Area Planning Manager (GW)
Principal Planning Officer (JH)
Planning Lawyer (IDP)
Governance Officer (RC)

111 SUBSTITUTES AND APOLOGIES

An apology of absence was received from Councillor Sue Burgoyne.

112 DECLARATION OF INTERESTS

None declared.

113 PL/18/27 TO CONFIRM THE MINUTES OF THE MEETING HELD ON 25 MARCH 2019

It was resolved that the Minutes of the meeting from 25 March 2019 were confirmed and signed as a true record subject to the following correction from the Governance Officer:

- That in minute 104.9, lines 2 and 3 the words “been” and “ongoing” are added to create the minute as follows:
- “The Agents responded to Members’ questions on issues including: that the basis for the height of the netting had been decided after a meeting with the cricket club, however the height could be changed and would be part of the

ongoing negotiations if Members were minded to approve the application.”

114 TO RECEIVE NOTIFICATION OF PETITIONS IN ACCORDANCE WITH THE COUNCIL'S PETITION SCHEME

None received.

115 SITE INSPECTIONS

None requested.

116 PL/18/28 PLANNING APPLICATIONS FOR DETERMINATION BY THE COMMITTEE

In accordance with the Council's arrangements for Public Speaking at Planning Committee, representations were made as detailed below relating to the items in Paper PL/18/28 and the speakers responded to questions put to them as provided for under those arrangements.

Application Number	Representations From
DC/18/02010	Helen Davies (Sproughton Parish Council) Rhona Jermyn (Objector) Martyn Levett (Objector) Paul Sutton (Agent) Cllr Christopher Hudson (County Council Ward Member) Cllr Nick Ridley (Ward Member)

It was RESOLVED

That subject to the imposition of conditions or reasons for refusal (whether additional or otherwise) in accordance with delegated powers under Council Minute No. 48(a) (dated 19 October 2004) decisions on the items referred to in Paper PL/18/28 be made as follows:-

117 DC/18/02010 LAND ON THE EAST SIDE OF BRAMFORD ROAD, SPROUGHTON, SUFFOLK

117.1 Due to the large amount of tabled papers associated with the application the Chair allowed Members extra time to consider the representations before the commencement of the item.

117.2 Item 1

Application Proposal	DC/18/02010 Planning Application. Residential Development of 54 dwellings with new vehicular access from Bramford Road, (B113), associated parking, landscaping and open space.
Site Location	SPROUGHTON- Land on the East Side of, Bramford Road, Sproughton, Suffolk.
Applicant	Hopkins Homes

117.2 The Case Officer presented the application to the Committee outlining the proposal before Members, the layout of the site, the content of the tabled papers (which included an updated officer recommendation) and the officer recommendation of approval with conditions.

117.3 Members considered the representation from Helen Davies of Sproughton Parish Council who spoke against the application.

117.4 Members considered the representation from Rhona Jermyn who spoke as an Objector.

117.5 Members considered the representation from Martyn Levett who spoke as an Objector.

117.6 The Objectors responded to Members' questions on issues including: the Sproughton Working Group and that it was not part of the Parish Council, the scale of the developments in the Gipping Valley and the amount of housing proposed within the village and the surrounding area.

117.7 Members considered the representation from Paul Sutton who spoke as the Agent on behalf of the Applicant.

117.8 The Agent responded to Members' questions on issues including: how quickly work could start on the site if Members were minded to approve the application, the impact on the listed buildings in the area, the identified need in the area, and the proposed footpath links.

117.9 Members considered the representation from Councillor Christopher Hudson, Suffolk County Council Ward Member.

117.10 The County Councillor responded to Members' questions on issues including: the strategic aims of the County Council with regards to housing, the sustainability of the proposal, and the current highways issues.

117.11 Members considered the representation from Councillor Nick Ridley, Ward Member.

117.12 Members debated the application on the issues including: the current status of policy CS2, the harm to the heritage asset, the updated flood zones as provided by the Environment Agency.

117.13 The Planning Lawyer advised Members that the decision maker had a special duty to pay with regard to the harm to heritage assets and the weight that Members associated with it.

117.14 The Area Planning Manager advised Members that the Council had been consistent in its approach to CS11.

117.15 Members continued to debate the application on the issues including: the number of affordable homes on the site, the current highways situation in Sproughton, the strategic allocations in the area, that there was no neighbourhood plan, the weight of Policy CS11 and the locally identified need in Sproughton.

117.16 Councillor Lee Parker proposed that the application be refused for the reasons as detailed below:

- The proposed development is considered to lead to a medium level of less than substantial harm to the setting of the Grade II listed buildings of Sproughton Hall, Root Barn and Tithe Barn and the Grade II* listed All Saints Church in Sproughton, which is not considered to respect the features that contribute positively to the setting of these listed buildings, conflicting with Babergh Local Plan (2006) policy CN06, and not respect the heritage characteristics of the village or historic views of heritage assets contrary to Babergh Core Strategy and Policies (2014) policies CS11 and CS15. Further to this, the public benefits of the scheme, namely the housing, affordable housing, net gain for biodiversity on the site, are not considered to outweigh this harm, making the proposal contrary to paragraph 196 of the National Planning Policy Framework 2019

117.17 Councillor David Busby seconded the motion.

117.18 **RESOLVED**

Members resolved to refuse the Application for the reasons below:

The proposed development is considered to lead to a medium level of less than substantial harm to the setting of the Grade II listed buildings of Sproughton Hall, Root Barn and Tithe Barn and the Grade II* listed All Saints Church in Sproughton, which is not considered to respect the features that contribute positively to the setting of these listed buildings, conflicting with Babergh Local Plan (2006) policy CN06, and not respect the heritage characteristics of the village or historic views of heritage assets contrary to Babergh Core Strategy and Policies (2014) policies CS11 and CS15. Further to this, the public benefits of the scheme, namely the housing, affordable housing, net gain for biodiversity on the site, are not considered to outweigh this harm, making the proposal contrary to paragraph 196 of the National Planning Policy Framework 2019

After the completion of the formal agenda the Chair thanked the Area Planning Manager Gemma Pannell for her service to the Council as she was leaving to join the Planning Inspectorate.

The Chair also gave special thanks to Councillors Ray Smith, Jennie Jenkins and David Rose who were not seeking re-election.

The business of the meeting was concluded at 11.34 am.

.....
Chair

This page is intentionally left blank

Application No: DC/18/02412 and DC/18/02010

Parish: Sproughton

Location: Land on the East Side of Bramford Road

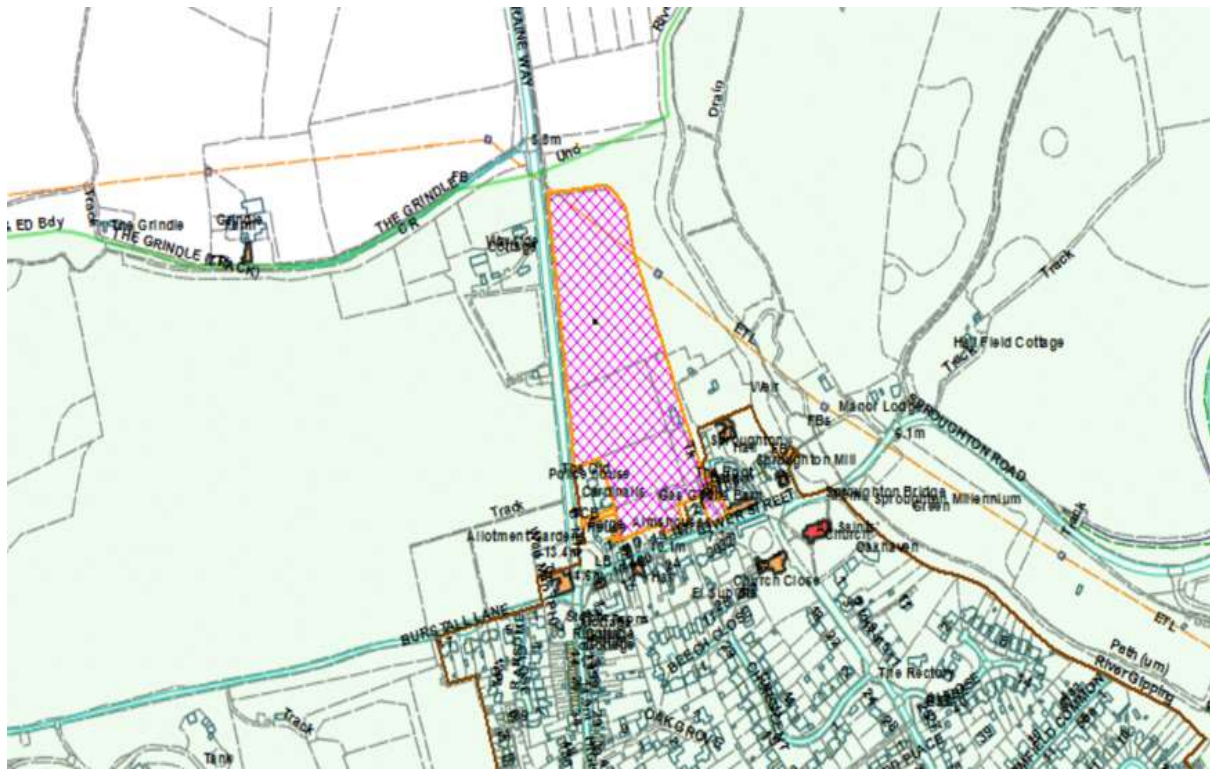

This page is intentionally left blank